

ALTERNATIVE 3: CIVIC EMPHASIS

Site Subsections

- R Ravine Corridor
- U Upper Terrace
- S Shoreline
- K Kite Parcel



Park Program Elements

- 01 Ravine enhancement (Contiguous canopy forested areas to be retained and enhanced; invasive plants removed)
- 02 Retain existing restroom, paths, roads and parking in ravine
- 03 Grand viewing plaza and terraces with ADA path to shoreline promenade
- 04 Parking area (15 to 25 on-street spaces along 99th)
- 05 Playground (for school-aged children)
- 06 Grass picnic area with shade structure
- 07 Swim Theater
- 08 Floating boardwalk with people propelled vessel launch
- 09 Retreat center with restrooms
- 10 Shoreline promenade with pedestrian and emergency vehicle access
- 11 Short-term marina parking (+/- 5 spaces) and dropoff area
- 12 Removal of Pier 3
- 13 Public viewing pier with 14 transient moorage slips
- 14 Main Street civic plaza with cascading water wall
- 15 Public art piece
- 16 Tucked under canoe and kayak storage/rental, artist studios
- 17 Whaling Building: Historical/Cultural Maritime Center
- 18 Enhanced hillside woodland (Removal of invasive species, preservation of significant trees, and planting of native forbs, shrubs and trees)
- 19 Artificial swim beach
- 20 Enhanced shoreline (improved nearshore habitat and addition of native riparian vegetation, including overhanging plants and woody debris)
- 21 Trail connects Lake-to-Lake Trail system

Marina Program	Existing	Alternative 3
Pier Removal	NA	Removes Pier 3 Roof off of Pier 2
Permanent Long-term Moorage	87 slips	37 to 58 slips
Not in Service/Transient	25 slips	14 slips North side of public pier
People Propelled Vessels (PPV)	No facilities	Up to 25 PPV slips Floating boardwalk & South side of public pier
Boat Storage	No facilities	In storage/rental space at end of Meydenbauer Way

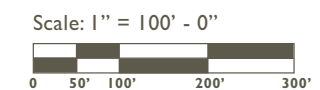

ALTERNATIVE 3: CIVIC EMPHASIS

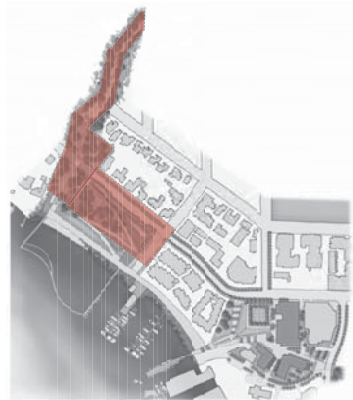

Key Map

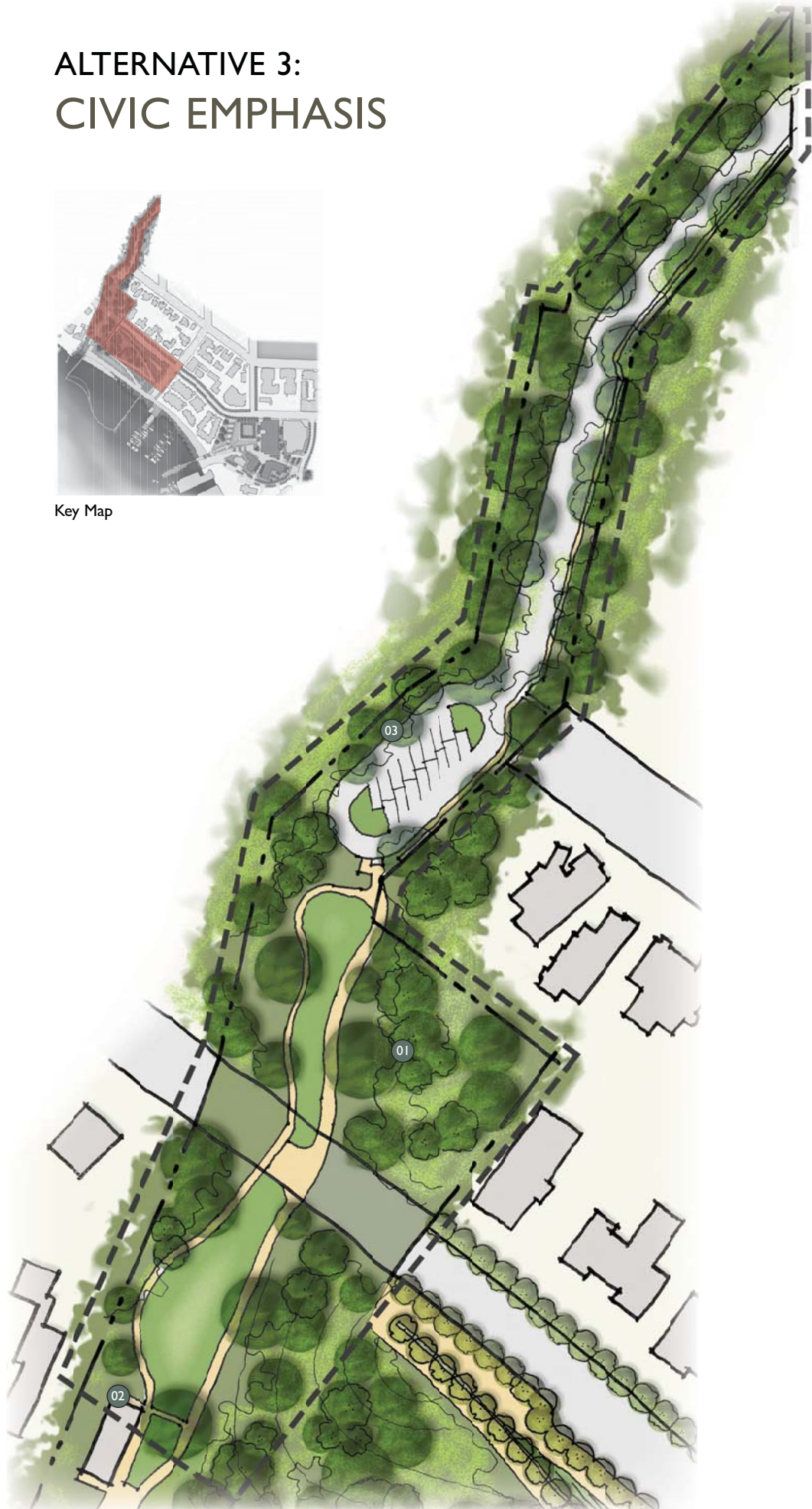

Ravine Corridor

- 01 Ravine enhancement (Contiguous canopy forested areas to be retained and enhanced; invasive plants removed)
- 02 Retain existing restroom
- 03 Retain existing paths, roads and parking in ravine

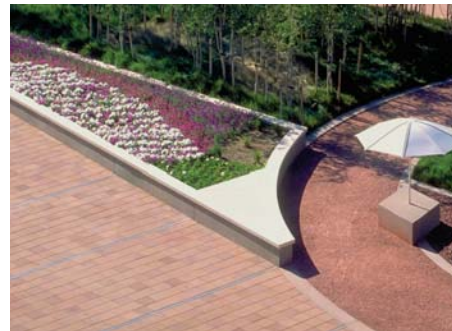

A



B



Upper Terrace

- 01 Grand viewing plaza and terraces
- 02 ADA path to shoreline promenade
- 03 Parking area (15 to 25 on-street spaces along 99th)
- 04 Enhanced hillside woodland (Removal of invasive species, preservation of significant trees, and planting of native forbs, shrubs and trees)

Scale: 1" = 50' - 0"
0 25' 50' 100' 150'

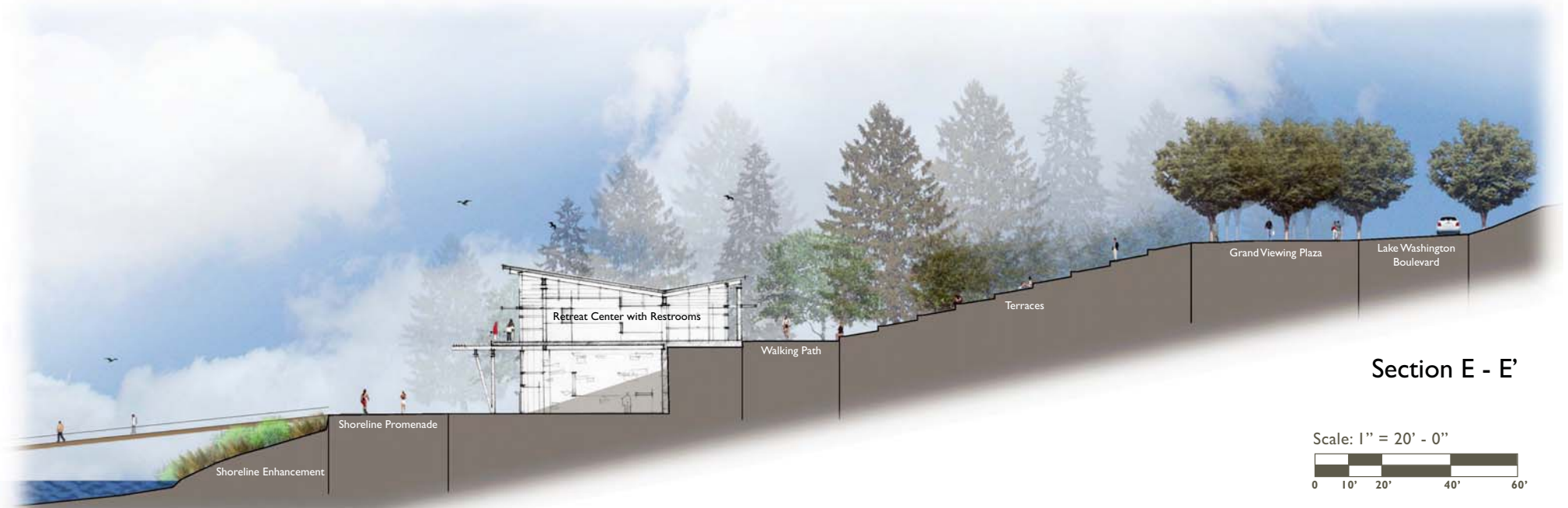

Section E - E'

Scale: 1" = 20' - 0"
0 10' 20' 40' 60'

ALTERNATIVE 3: CIVIC EMPHASIS

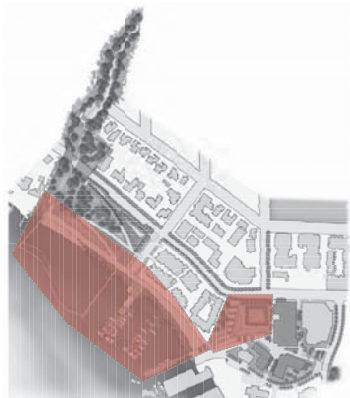

Key Map

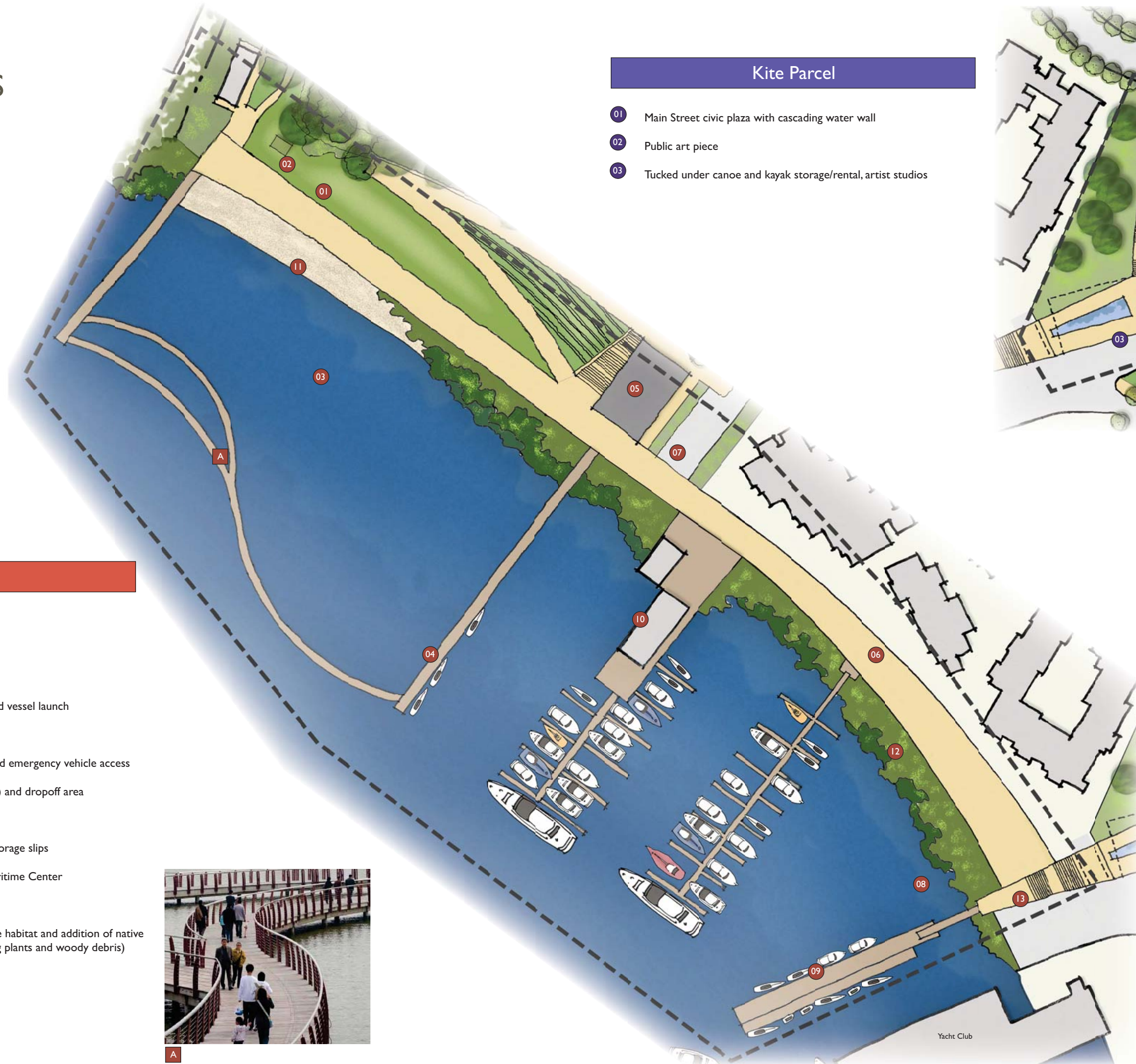

Kite Parcel

- 01 Main Street civic plaza with cascading water wall
- 02 Public art piece
- 03 Tucked under canoe and kayak storage/rental, artist studios

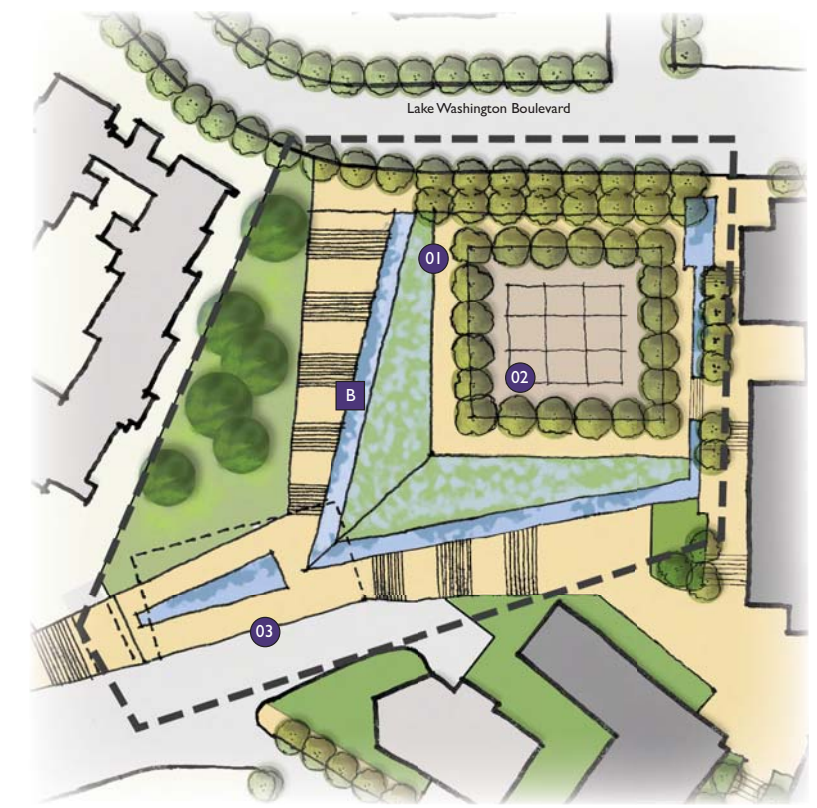

B

Shoreline

- 01 Playground (for school-aged children)
- 02 Grass picnic area with shade structure
- 03 Swim Theater
- 04 Floating boardwalk with people propelled vessel launch
- 05 Retreat center with restrooms
- 06 Shoreline promenade with pedestrian and emergency vehicle access
- 07 Short-term marina parking (+/- 5 spaces) and dropoff area
- 08 Removal of Pier 3
- 09 Public viewing pier with 14 transient moorage slips
- 10 Whaling Building: Historical/Cultural Maritime Center
- 11 Artificial swim beach
- 12 Enhanced shoreline (improved nearshore habitat and addition of native riparian vegetation, including overhanging plants and woody debris)
- 13 Trail connects Lake-to-Lake Trail system



A

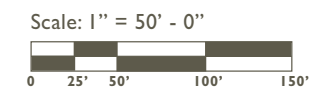

ALTERNATIVE 3: CIVIC EMPHASIS

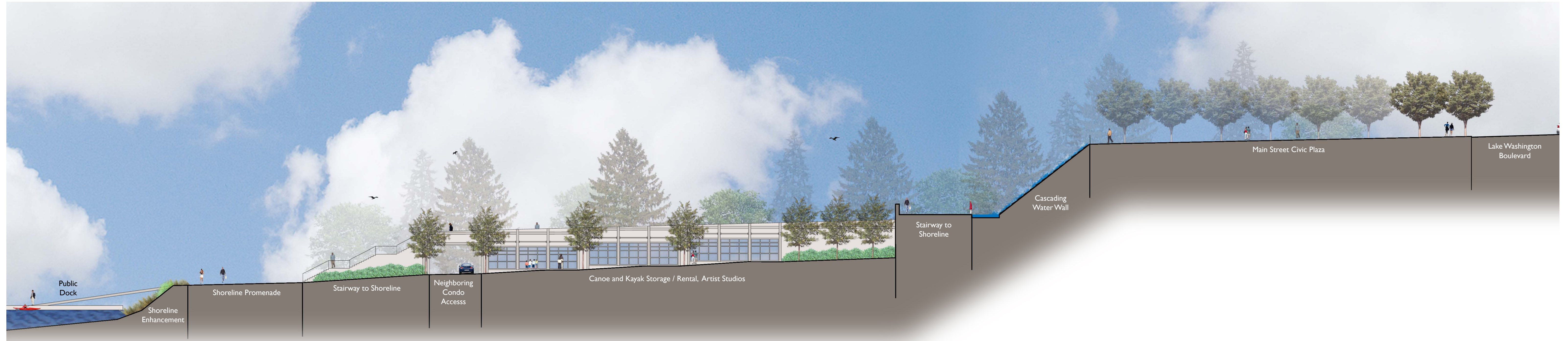

Section F - F'
Scale: 1" = 20' - 0"
0 10' 20' 40' 60'