

# EASTSIDE MEN'S SHELTER AND SUPPORTIVE HOUSING

A partnership between City of Bellevue, King County, King County Public Health, Congregations for the Homeless and Imagine Housing.

Eastside Men's Shelter and Supportive Housing

September 29, 2016

# Eastside Response

## Community driven / local agencies

- Congregations for the Homeless
- Hopelink
- Friends of Youth
- Lifewire
- Sophia's Way
- Imagine Housing

Sub-regional collaboration with neighboring cities

Regional All Home King County coordination

# Facts and Figures

- Over 1200 homeless persons served in shelter last year on the Eastside
- 245 people sleeping outside in 2016 Eastside One Night Count of unsheltered individuals
- 571 unduplicated clients served at Men's Shelter in 2015-16

# Bellevue Policy Basis

- 2016-17 Council Vision Priorities
  - “Establish an eastside permanent winter homeless shelter to be ready for the winters of 2018-2019”
- 2015 Updated Comprehensive Plan Policies
- 2015 Interest Statement on Homelessness
- 2014 Bellevue Diversity Advantage action plan

# Eastgate Public Health Site



# Public Health Site

- Two building pad options on the property
- Both challenging, but feasible

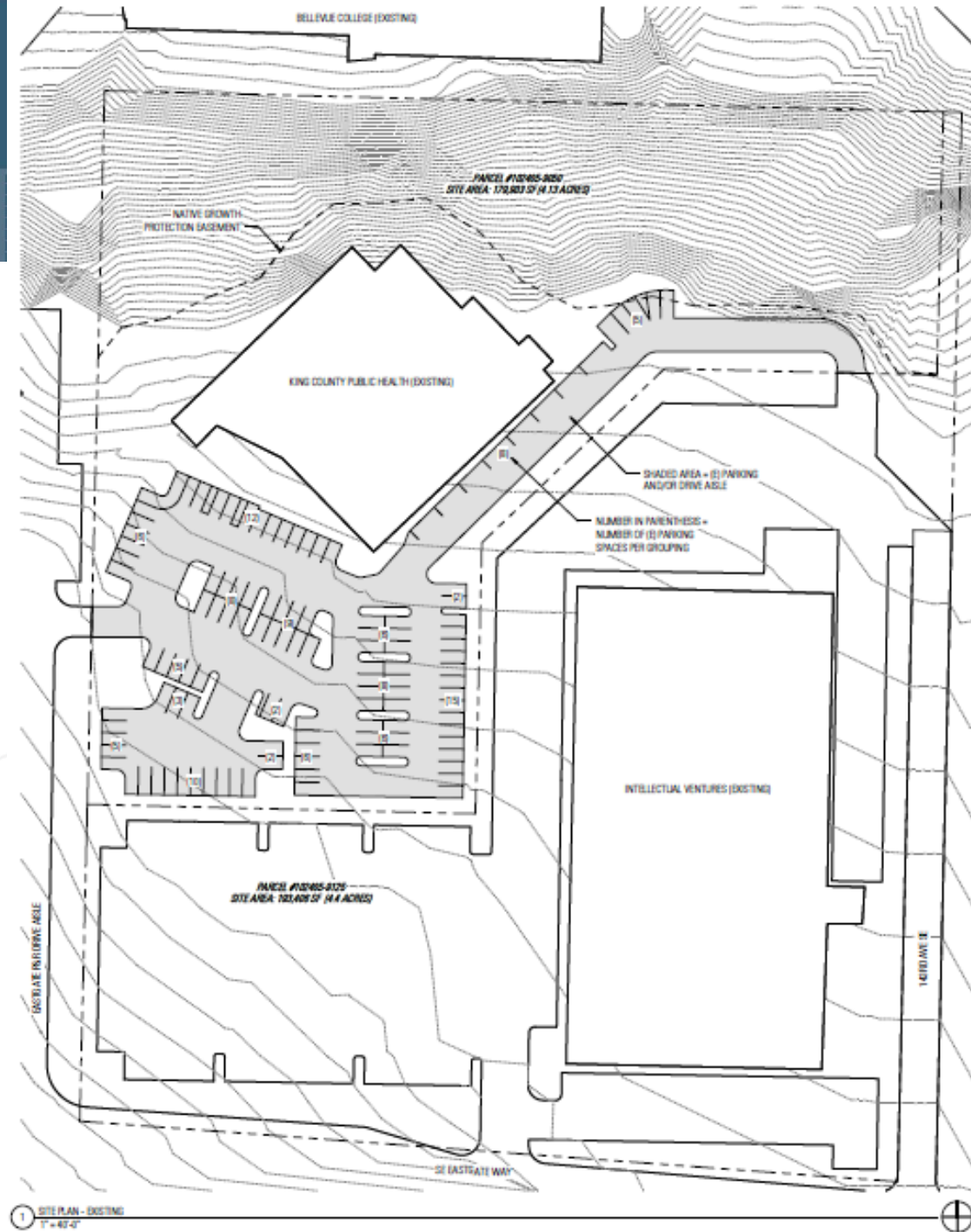

# What Imagine Housing Brings

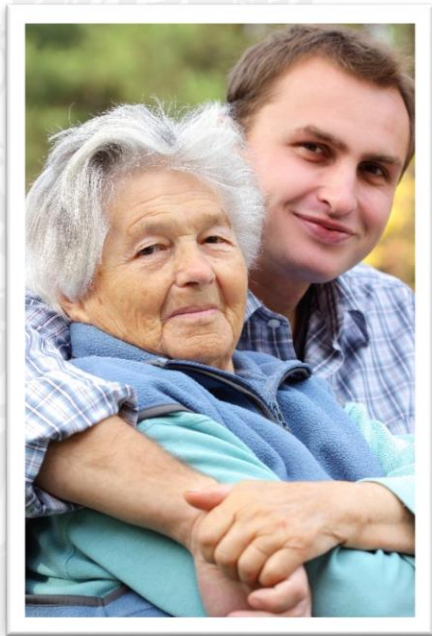

- Permanent Housing
- Developer Experience
- Financial Stability
- Supportive Services



**Resource  
Referrals**

**Community  
Engagement**

**Case  
Management**

**On-Site  
Support Staff**



**Imagine Housing**  
building eastside communities

# Recent Developments

Velocity, South Kirkland Park & Ride



Andrew's Glen, Bellevue



Francis Village, Kirkland



Imagine Housing  
building eastside communities



# Coming Soon

## Athene, Kirkland

91 units for seniors  
Coming Fall 2017



## 30Bellevue, Bellevue

62 units for large and small households  
Coming Winter 2018



# Mission - Congregations for the Homeless



End homelessness on the Eastside  
by helping men make the transition from  
life on the street to stable, independent  
living.

# History of CFH Programs

- 1993 Year Around Shelter
- 2005 Comprehensive Case Management
- 2006 Subsidized Housing
- 2008 Eastside Winter Shelter
- 2013 Day Center

# Who CFH Winter Shelter Serves

571 men served 2015-16 winter shelter

309 were formerly Bellevue residents

# Men's Shelter & Day Services

## Congregations for the Homeless (CFH)

- Emergency Shelter - 100 beds
- Drop-in Day Center & Cafeteria
- Services to be available on-site
  - Case management
  - Housing placement
  - Medical and dental services
  - Mental Health services
  - Addiction recovery
  - Employment support
  - DSHS benefit enrollment
  - Legal assistance

# Men's Shelter & Housing: Best Practices

- Nativity House - Tacoma



# Safety and Security

- Safety is Paramount
  - Safety for Community
  - Safety for Clients
  - Safety for Staff

Rules developed based on each community  
(4 locations since 2008)

Staff trained in conflict management

Collaboration with Police

- Police have resource for people in distress
- Respond to staff requests for assistance

# Shelter & Day Center Operations

- Shelter Opens
- Dinner served, community formed, case management appointments, etc
- Curfew – no one turned away into neighborhood
- Breakfast served, transition to day services
- Day Center Opens, Shelter dorm closed
- Case Management, Counseling, Resources, Visiting professionals from VA, Addiction, Mental Health Counseling.



# Community = CFH Core Value

Invitation to visit Congregations for the Homeless programs

Ongoing Communication with Community is crucial in success of our programs

Community Stakeholders group forming to advise on shelter design and ongoing operational feedback

# Congregations for the Homeless



**CFH**

**CONGREGATIONS FOR THE HOMELESS**

*from homelessness to housing, one man at a time*

# Break for Questions & Comments

## Questions

- Write questions on cards provided. 1 question per card please
- Will collect and answer tonight (if possible)
- Follow up at workshop October 27<sup>th</sup> at 7:00  
Champion Centre

## Comments

- Shared with community and included in report to council

# 2<sup>nd</sup> Community Meeting – Oct 27<sup>th</sup>

## Workshop Format

Participants will have the opportunity to clarify and prioritize the feedback and evaluate possible solutions to the issues identified so far in the process.

Where: Champion Center, 2649 145<sup>th</sup> Place SE

When: October 27<sup>th</sup> 7:00 pm.

# Community Outreach

Surrounding  
businesses  
and residents

Stakeholder  
briefings

Community  
Meetings

Compilation  
Report back  
by Q1 2017

- Interested Parties List
- CFH Community Stakeholder Group
- Information and events for surrounding community
- <http://www.bellevuewa.gov/eastside-mens-shelter.htm>

# Contacts & Websites

- Join Interested Parties List – Receive up to date information:  
<http://www.bellevuewa.gov/eastside-mens-shelter.htm>
- Provide input and ask questions:  
[MMHuent@bellevuewa.gov](mailto:MMHuent@bellevuewa.gov)
- Congregations for the Homeless [www.cfhomeless.org](http://www.cfhomeless.org)  
[steve@cfhomeless.org](mailto:steve@cfhomeless.org)
- Imagine Housing [www.imaginehousing.org](http://www.imaginehousing.org)  
[sglasby@imaginehousing.org](mailto:sglasby@imaginehousing.org)