

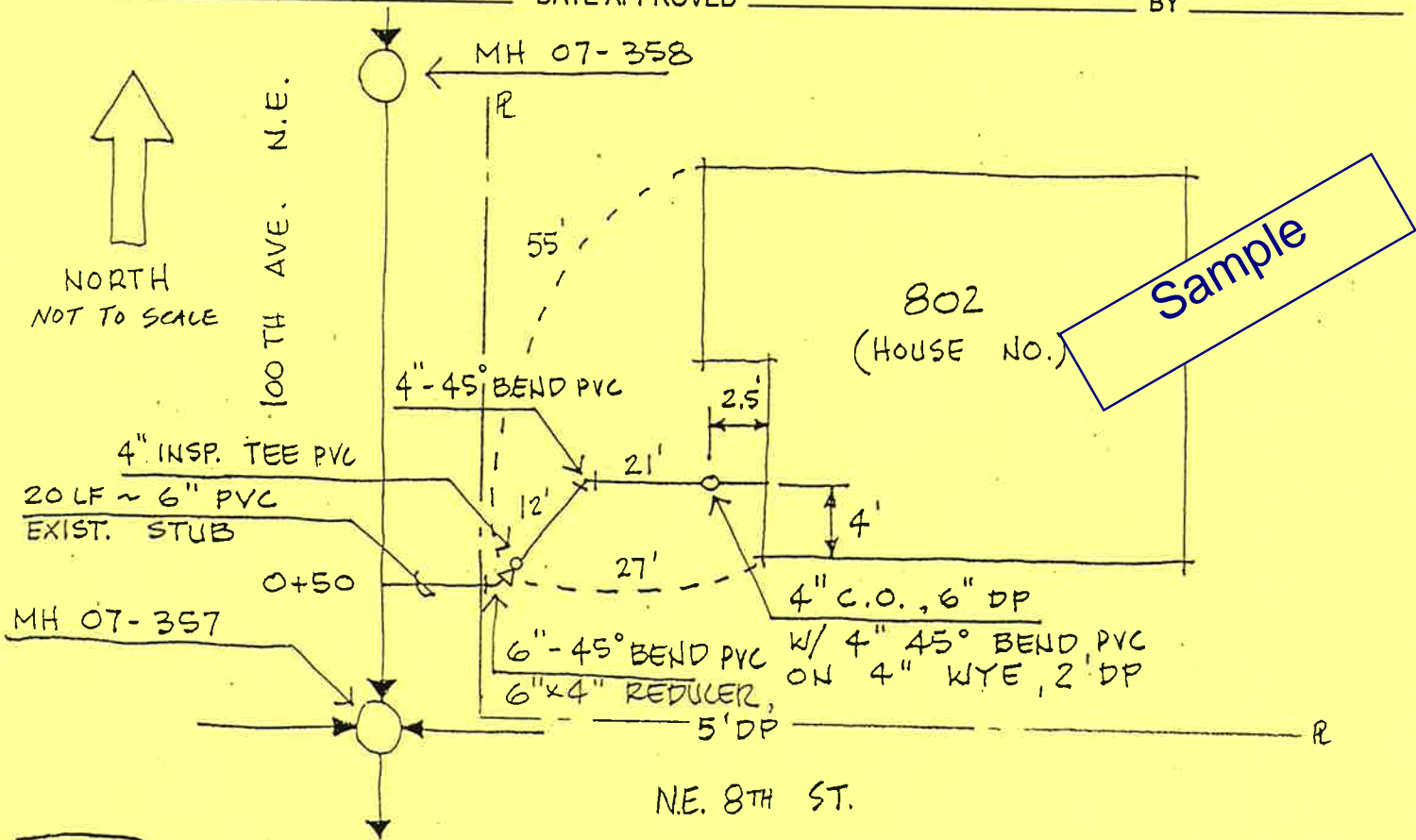

SIDE SEWER AS-BUILT

ADDRESS 802 - 100th AVE N.E. CITY BELLEVUE PERMIT NO. 99-997336UA
 CONTRACTOR COBB'S SEWER SVC, INC CLN COBBSSI005LF DRAWN BY C. BROOKES
 DATE PERMIT ISSUED 12-31-99 DATE APPROVED _____ BY _____



COMMERCIAL OR DOMESTIC JOINT USE: YES (NO) HOW TESTED: AIR WATER
 DIST FROM MH. NO. 07-357 TO TEE 50 FT. LEGAL DESCRIPTION: LOT 4 OF MEYDENBAUER ADDITION
 DEPTH OF SEWER MAIN AT TEE 8.5 FT.
 DEPTH OF SIDE SEWER AT PROPERTY LINE 5 FT.
 BASEMENT: YES (NO) BASEMENT CONNECTION: YES (NO)
 DEPTH OF PIPE AT HOUSE CONNECTION 2 FT.
 TYPE OF PIPE: (PVC) CONC D.I. OTHER _____ K.C. TAX# 6907518004
 SIZE OF PIPE: (4") 6" 8" C.O.B. GRID NO. E-6
 CONNECTION AT MAIN: CUT IN TEE HOLE CUT (EXIST. STUB)



CITY OF BELLEVUE
Utilities/Engineering
450 110th Ave. NE
Bellevue, WA 98004

SIDE SEWER AS-BUILT

ADDRESS _____ CITY _____ PERMIT NO. _____
CONTRACTOR _____ LIC. NO. _____ DRAWN BY _____
DATE APPROVED _____ BY _____

DIST FROM MH. NO _____ TO TEE _____ FT.
COB GRID NO. _____
DEPTH OF SIDE SEWER AT PROPERTY LINE _____ FT.
DEPTH OF PIPE AT HOUSE CONNECTION _____ FT.

COMMERCIAL OR DOMESTIC JOINT USE: YES NO
BASEMENT CONNECTION: YES NO DON'T KNOW
HOW TESTED: AIR WATER
CONNECTION AT MAIN: CUT TO TEE HOLE CUT EXIST. STUB