



Transportation Department
450 110th Avenue NE
PO Box 90012
Bellevue WA 98009-9012

PRSR STD
U.S. POSTAGE
PAID
SEATTLE, WA
PERMIT No. 4



NE 12th Street Multipurpose Path

NE 12th Street Multipurpose Path

NE 12th Street 多用途通道

May 2020

ECRWSS
Postal Patron

Dear Neighbor,

As a resident near NE 12th Street, you value the closeness of McCormick Park and easy access from your neighborhood. As you may know, the city is in the final stages of design for a multipurpose path along NE 12th Street, between 112th Avenue NE and 108th Avenue NE.

The city truly appreciates suggestions expressed by nearby neighbors to redesign the multipurpose path, build it elsewhere or not build it. These comments helped staff focus on achieving the project's intent and fine tune the design to best fit alongside the park. The current design achieves many goals:

- Creates a safe route for pedestrians and bicyclists on a new 12-foot wide multipurpose path along NE 12th Street.
- Uses the public right-of-way along the north side of NE 12th Street to accommodate a long-planned project. Space constraints along the south side of NE 12th Street do not allow for a 12-foot width multipurpose path; also, driveways to and from the Downtown Bellevue Library may be hazardous for people walking and riding a bicycle.

- Provides a direct and contiguous connection for people riding bicycles between Downtown and BelRed as part of the planned Downtown-Overlake priority bicycle corridor.

As Bellevue's job and population growth continues, the transportation system must keep up with the demand for a variety of travel options, including transit, walking, biking and driving.

Project features

Design elements for the multipurpose path will have a minimal impact on how McCormick Park has historically functioned:

- Expands the existing 5-foot wide sidewalk to a 12-foot wide multipurpose path.
- Expands the current planter strip from 3 feet to 5 feet in width.
- Buffers the multipurpose path from the roadway with landscaping.
- Restores landscaping impacted by construction.
- Retains the existing gravel path within the park.
- Adds signage with safety messages along the path.

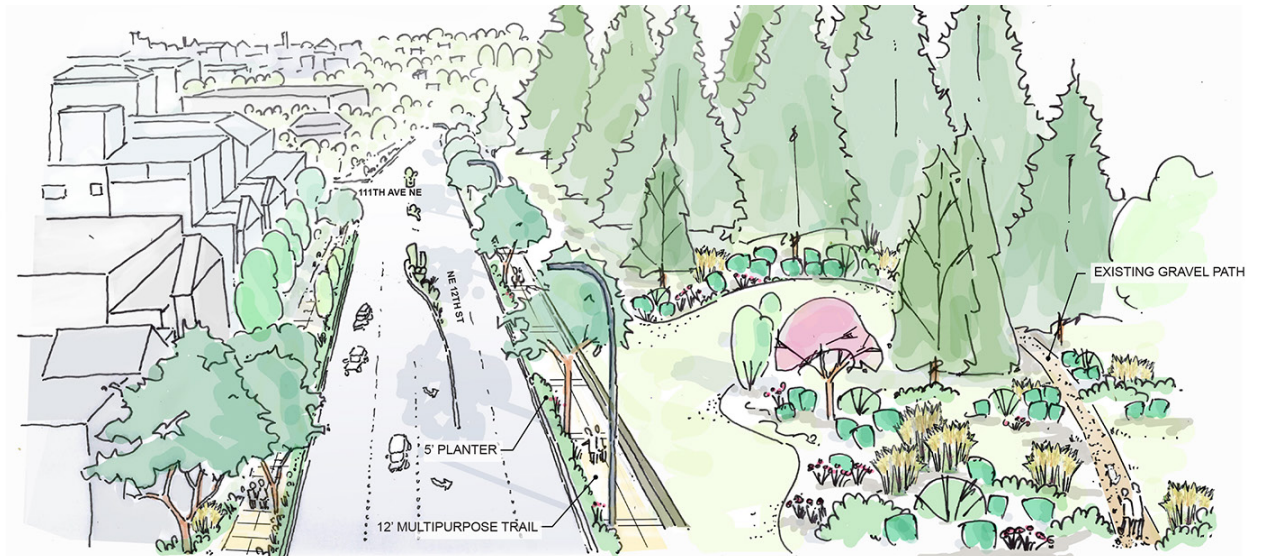

NORTH

NE 12th Street Multipurpose Path • Rendering

TRN-20-5494



Title VI Notice to the Public: It is the City of Bellevue's policy to assure that no person shall on the grounds of race, color, national origin or sex, as provided by the Title VI of the Civil Rights Acts of 1964, be excluded from participating in, be denied the benefits of, or be otherwise discriminated against under any of its federally funded program and activities. Any person who believes his/her Title VI protection has been violated may file a complaint with the Title VI Coordinator. For Title VI complaint forms and advice, please contact the Title VI Coordinator at 425-452-4496.

For alternate formats, interpreters, or reasonable accommodation requests please phone at least 48 hours in advance 425-452-2064 (voice) or email mjensen@bellevuewa.gov. For complaints regarding accommodations, contact City of Bellevue ADA/Title VI Administrator at 425-452-6168 (voice) or email ADATitleVI@bellevuewa.gov. If you are deaf or hard of hearing dial 711. All meetings are wheelchair accessible.

若您需要活動採用其他形式，或者需要幫助排除其他妨礙你參與活動的障礙，請至少於48小時前致電425-452-6168 或電郵 email mjensen@bellevuewa.gov 通知我們。投訴請撥425-452-6168 聯繫貝爾維尤市「美國身心障礙者法案/反歧視法」之管理員聯絡。聽障或重聽人士請撥711。所有會議皆有無障礙通道。



Information 425-452-6800

Information 425-452-6800

Information 425-452-6800

Information 425-452-6800

NE 12th Street Multipurpose Path

NE 12th Street 多用途通道

Project schedule

- Project design is expected to be completed in July.
- Contract bid and award is expected to be completed by August.
- Construction is anticipated to begin in fall 2020 and last through spring 2021.
- Construction schedules are subject to change. Some work is weather dependent.

Construction impacts

- Approved work hours: 7 a.m. to 3:30 p.m., Monday through Friday.
- Expect single lane closure of the westbound lane of NE 12th Street.
- All construction work will be conducted behind the existing curb except during the

construction of the accessibility (ADA) ramps, which includes the curb and gutter.

To receive traffic alerts, subscribe at BellevueWA.gov/trafficadvisories

Construction funding

This project is funded by the Downtown Transportation Plan Implementation Program and the construction estimate at the 90% design mark is \$1.2 million.

Information

BellevueWA.gov/12th-street-multipurpose

Sara Haile, project manager
425-452-7835
shaile@bellevuewa.gov



NE 12th Street Multipurpose Path • Rendering

NE 12th Street Multipurpose Path • Vicinity Map

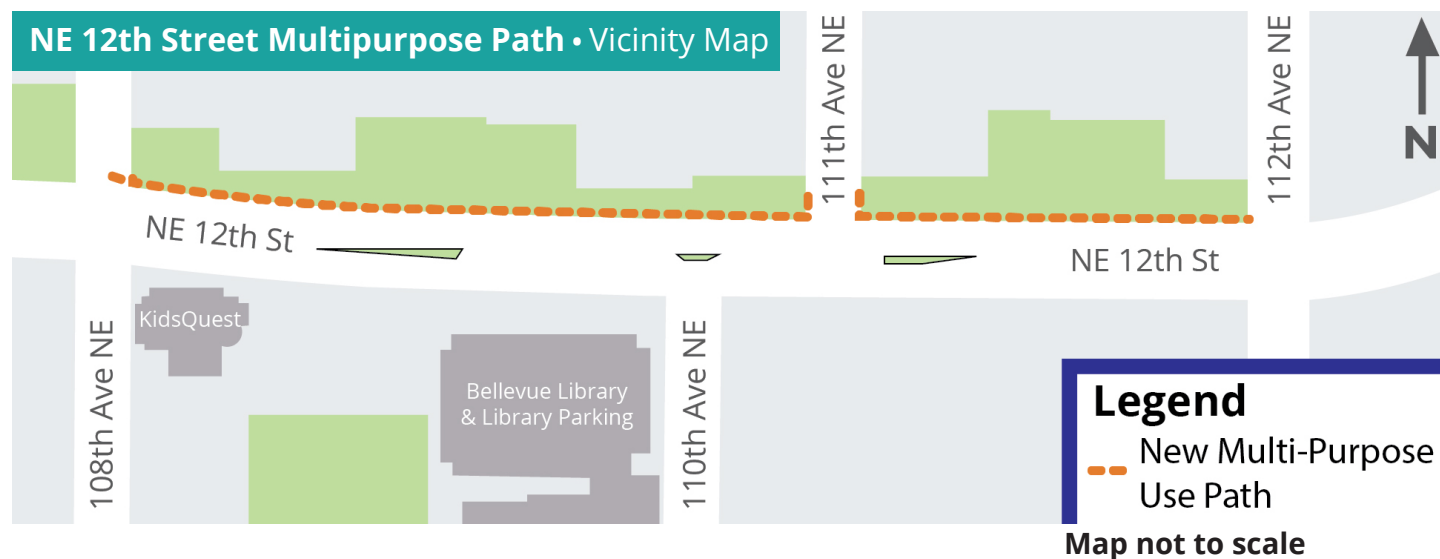

NE 12th Street 多用途通道

親愛的鄰里：

作為 NE 12th Street 附近居民，您重視與 McCormick Park 毗鄰的位置和方便的交通。如您所知，市政府將沿著 NE 12th Street，在 112th Avenue NE 和 108th 之間修築一條多用途通道，此項目現正處於最後的設計階段。

對市政府而言，臨近社區提出的對於重新設計多用途通道、另址建造或取消建造的建議極為重要。這些建議可幫助工作人員專注於實現項目意圖，改善設計，以最優化適配該公園。當前設計可滿足多個目的：

- 沿 NE 12th Street 為行人和腳踏車騎士創造一個 12 英尺寬的全新多用途安全通道。
- 使用 NE 12th Street 北側的公共路權來容納這一計畫已久的項目。NE 12th Street 南側空間限制無法允許建造 12 英尺寬的多用途通道，且來往 Downtown Bellevue Library 的車道也可能對行人和腳踏車騎士構成危險。
- 作為計畫中 Downtown-Overlake 腳踏車優先通道的組成部分，該通道為 Downtown 和 BelRed 之間的腳踏車騎士提供直接和連續的道路連接。

隨著 Bellevue 市工作機會和人口持續增長，交通系統必須滿足多種出行選項的需求，包括公共交通、步行、騎車和駕車。

項目特點

多用途通道設計元素對 McCormick Park 現有功能的影響將控制到最小：

- 現存 5 英尺寬的人行道拓寬為 12 英尺寬的多用途通道。
- 現存 3 英尺寬的綠化帶拓寬為 5 英尺。
- 用景觀將多用途通道和道路隔開。

- 復原被建造過程所影響的景觀。
- 保留公園內現存的礫石小路。
- 在通道邊樹立安全提示標識。

項目工期

- 項目設計預計於 7 月完成。
- 工程招標預計於 8 月完成。
- 工程預計於 2020 年秋季開始，並持續到 2021 年春季。
- 工期可能會發生變化。部分施工取決於天氣。

工程影響

- 批准的工作時間：週一至週五上午 7:00 至下午 3:30。
- 預計 NE 12th Street 往西的車道將被關閉。
- 所有建造工作將在現存的馬路沿外進行，建設無障礙 (ADA) 斜坡時除外，因為其包括對馬路沿和排水溝的改造。

如需獲取交通提示，請訂閱

BellevueWA.gov/trafficadvisories

工程資金

此項目由 Downtown Transportation Plan Implementation Program 提供資金，工程預計 90% 設計估值為 120 萬美元。

資訊

BellevueWA.gov/12th-street-multipurpose

Sara Haile, project manager | 425-452-7835
shaile@bellevuewa.gov