

Neighborhood Enhancement Program

Wilburton NEP Funded Project Location

NEP NEWSLETTER

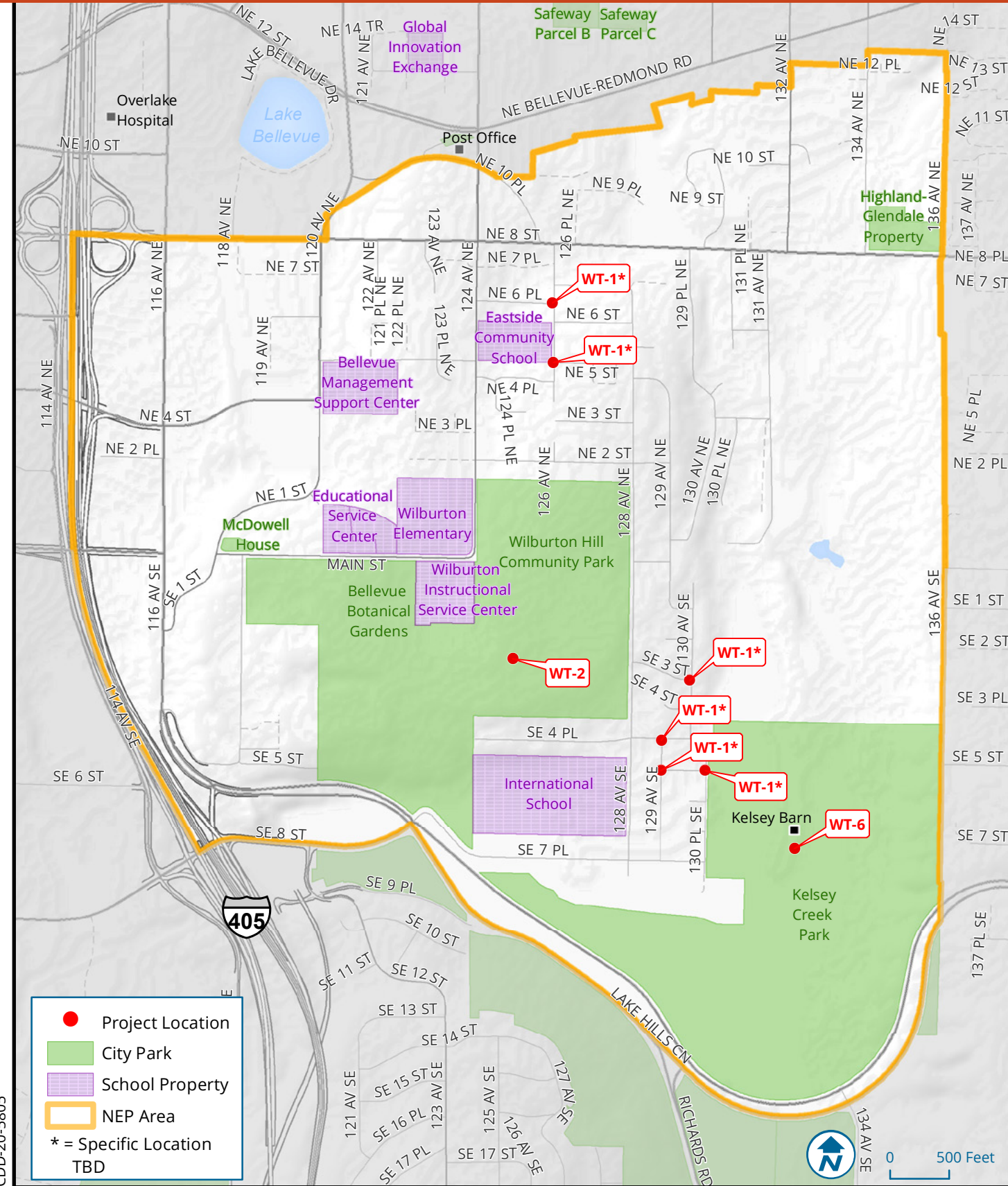

Wilburton

In September and October 2020, 281 ballots were returned on the 10 proposed enhancement projects to receive Neighborhood Enhancement Program (NEP) funds. 3 projects will be funded out of the \$133,000 Wilburton NEP allocation, which will also encompass associated planning, design, labor and materials fees.

Please take a moment to complete the enclosed, prepaid NEP evaluation form, and mail it back to us. Your feedback is critical to ensuring that the Neighborhood Enhancement Program is meeting your needs, as well as informing planning decisions, program improvement, and policy development. You can also complete the evaluation form online via the NEP website (BellevueWA.gov/nep). Kindly return your completed form or submit your comments online by December 30, 2020.

As we begin the implementation phase, we encourage you to remain engaged in the process by contacting project managers to provide input, tracking the status of the projects on the NEP website, and enjoying the built work!

Please Return Enclosed Evaluation Form or submit comments online at BellevueWA.gov/nep and Final Result Inside

The City of Bellevue
Neighborhood Enhancement Program
Wilburton Newsletter



Community Development Department
PO Box 90012
Bellevue, WA 98009-9012

PRSR STD
U.S. POSTAGE
PAID
PERMIT #61
BELLEVUE, WA

CDD-20-5805

Funded projects to be implemented by Neighborhood Enhancement Program over the next three to five years.

**WT-1: Wilburton Corner Street Lighting
\$20,000 277 points**

This project will install new LED streetlights on existing PSE utility poles at select intersections of neighborhood streets in the Wilburton area. Up to six (6) new streetlights will be installed. Ongoing electricity costs will be paid for by the city.

Project Manager: Max Scheideman
425-452-6141; mscheidema@bellevuewa.gov

**WT-2: Wilburton Park Ivy Out
\$75,000 230 points**

This project will involve the removal of non-native English ivy (*Hedera helix*) from natural forested areas within Wilburton Hill Park. The scope of work will involve removal of English ivy from the forest floor and removal of ivy growing up existing native trees. Although ivy will be the primary target, other non-native invasive weeds such as hawthorn, Himalayan blackberry and periwinkle will also be removed. All the areas impacted by the removal of invasive weeds will be replanted with native trees and shrubs that are suitable for site conditions. The new plantings will be watered and maintained by city staff until they are established and self-sustainable. This project will result in a more diverse and healthy forest ecosystem at Wilburton Hill Park that will enhance wildlife habitat and improve ecosystem functions.

Project Manager: Rick Bailey 425-452-6031;
ribailey@bellevuewa.gov

**WT-6: Kelsey Pollinator Interpretive Display
\$30,000 197 points**

Bees are excellent pollinators and essential for life on earth. Bees alone are responsible for about one-third of the food we eat. Agriculture is highly dependent on honeybees. Honeybee populations have been in decline for the past decade. This project will create a living, interactive interpretive exhibit at Kelsey Creek Farm. The exhibit will include an observation hive, interpretive signage, and possibly incorporate installation of non-stinging mason bee nests in the park.

Project Manager: Jammie Kingham
425-452-6048; jkingham@bellevuewa.gov

Questions/Concerns?

Contact the following individuals regarding the following topics:

Neighborhood Enhancement Program
Theresa Cuthill
425-452-4186 | tcuthill@bellevuewa.gov

Wilburton Neighborhood Liaison
Julie Ellenhorn
425-452-5372 | jellenhorn@bellevuewa.gov

 For alternate formats, interpreters, or reasonable accommodation requests please phone at least 48 hours in advance 425-452-4186 (voice) or email tcuthill@bellevuewa.gov. For complaints regarding accommodations, contact City of Bellevue ADA/Title VI Administrator at 425-452-6168 (voice) or email ADATitleVI@bellevuewa.gov. If you are deaf or hard of hearing dial 711. All meetings are wheelchair accessible.

Overall Wilburton Project List and Final Vote Results:

Ballot#	Project	Costs	Points
WT-1	Wilburton Corner Street Lighting	\$20,000	277
WT-2	Wilburton Hill Park Ivy Out	\$75,000	230
*WT-6	Kelsey Pollinator Interpretive Display	\$30,000	197
WT-7	NE 8th Declining Street Tree and Turf Replacement	\$125,000	226
WT-9	Wilburton Bikeway Enhancements	\$75,000	202
WT-10	SE 7th Place New Walking Path and Associated Improvements	\$118,500	180
WT-3	Courtyard Seating Wall (@Botanical Gardens)	\$75,000	95
WT-5	NE 8th Street Children's Tiles	\$54,000	95
WT-8	Neighborhood Gateway	\$75,000	74
WT-4	Pedestrian Wayfinding Signage	\$30,000	50

*Three of ten proposed projects will be funded. The first two projects can be funded. There are not enough funds to include the third or fourth selected projects, however, it was determined that the fifth selected project will be funded in order to utilize the maximum amount of NEP funding available to the neighborhood area.

