

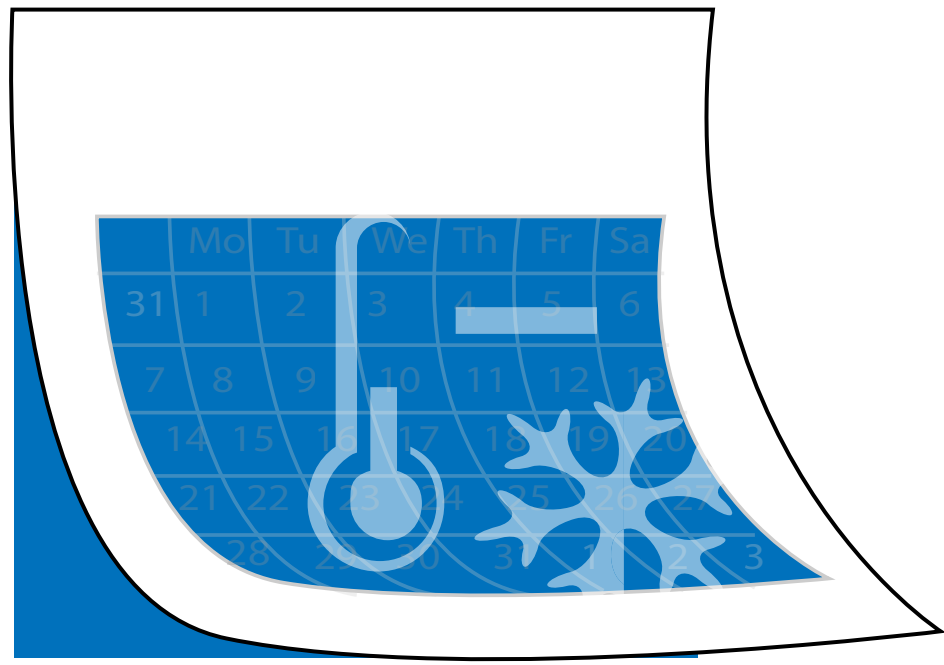

# When



FROM NOVEMBER TO MARCH

# What



SOMETIMES ACCOMPANIED BY SNOW AND FLOOD



POWER OUTAGES

## IF INSIDE



### What to do

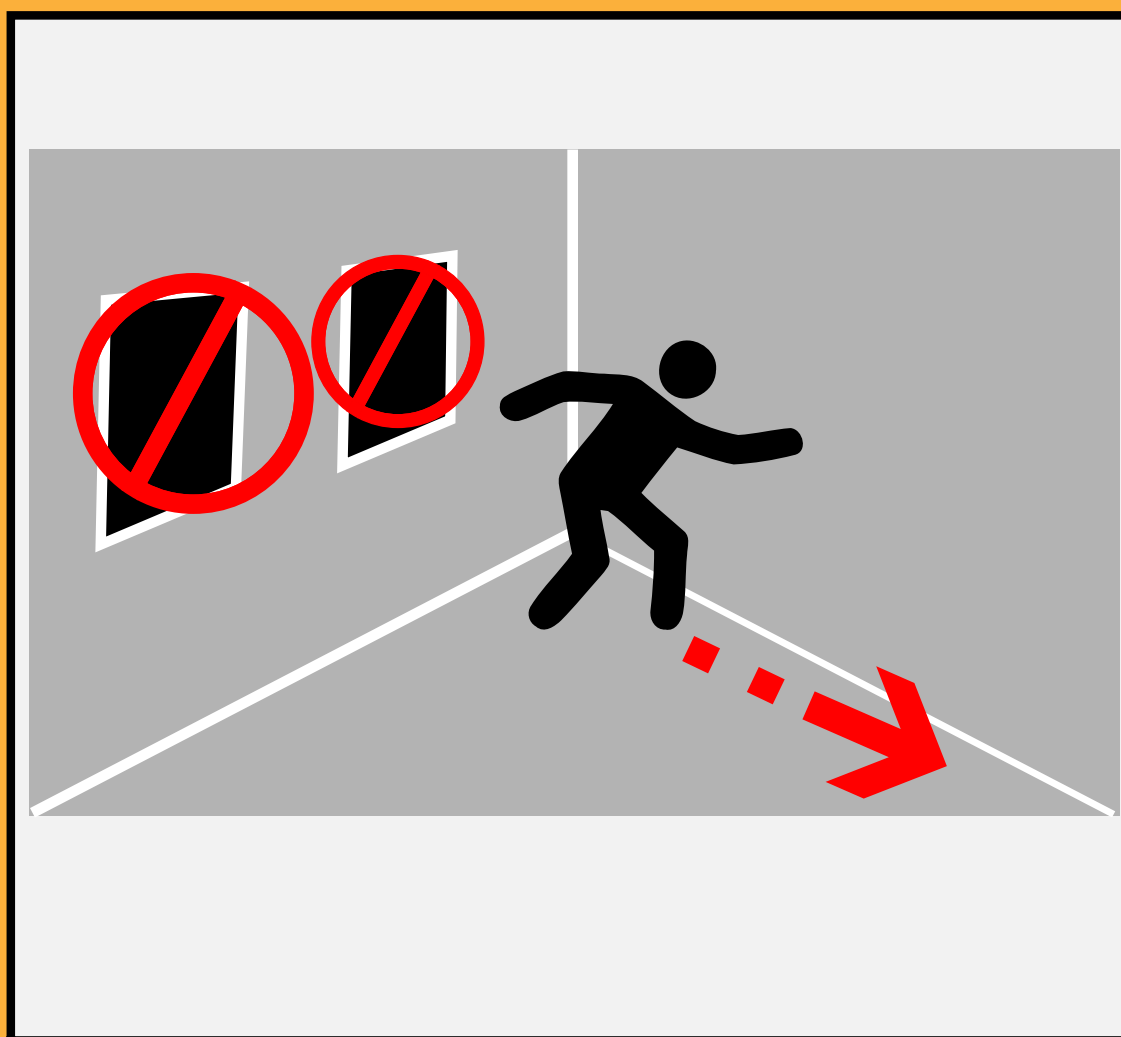

STAY AWAY FROM WINDOWS!

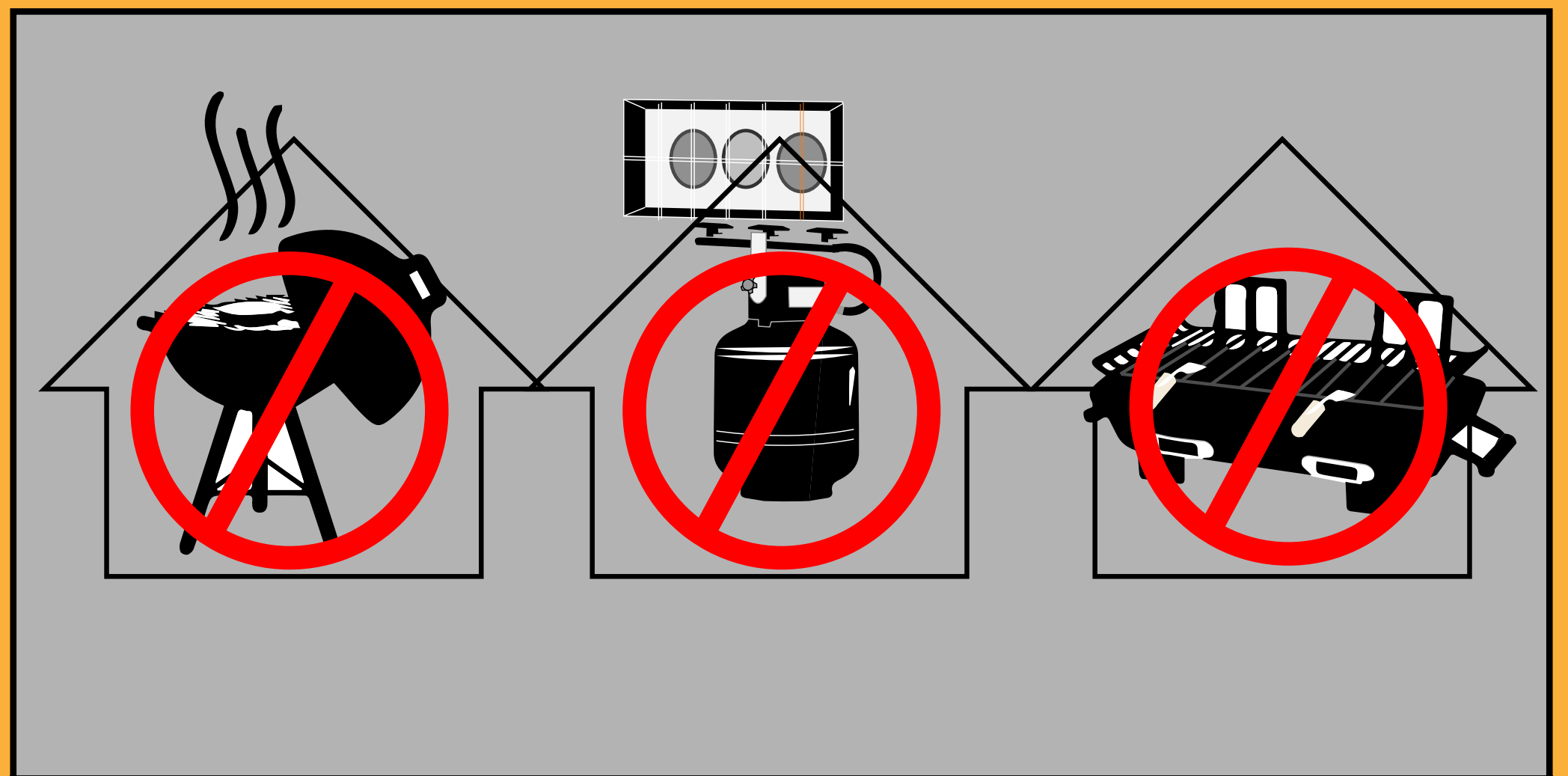

HEAT YOUR HOUSE USING APPROVED MECHANISMS  
NO GRILL, PROPANE HEATER OR HIBACHI INDOORS!



## IF OUTSIDE

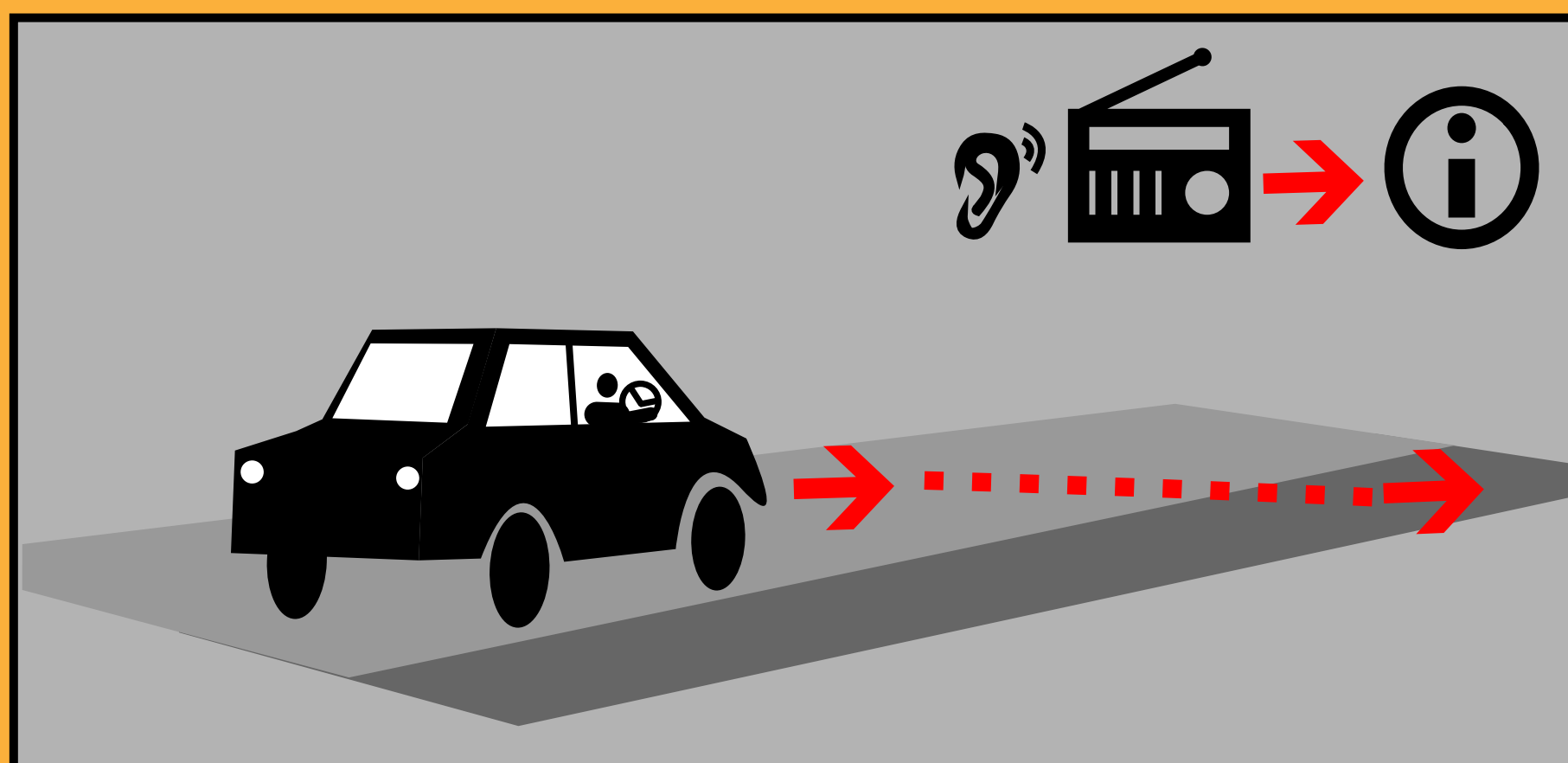

IF DRIVING, PULL OVER TO THE SIDE OF THE ROAD AND LISTEN TO THE RADIO FOR INSTRUCTIONS!

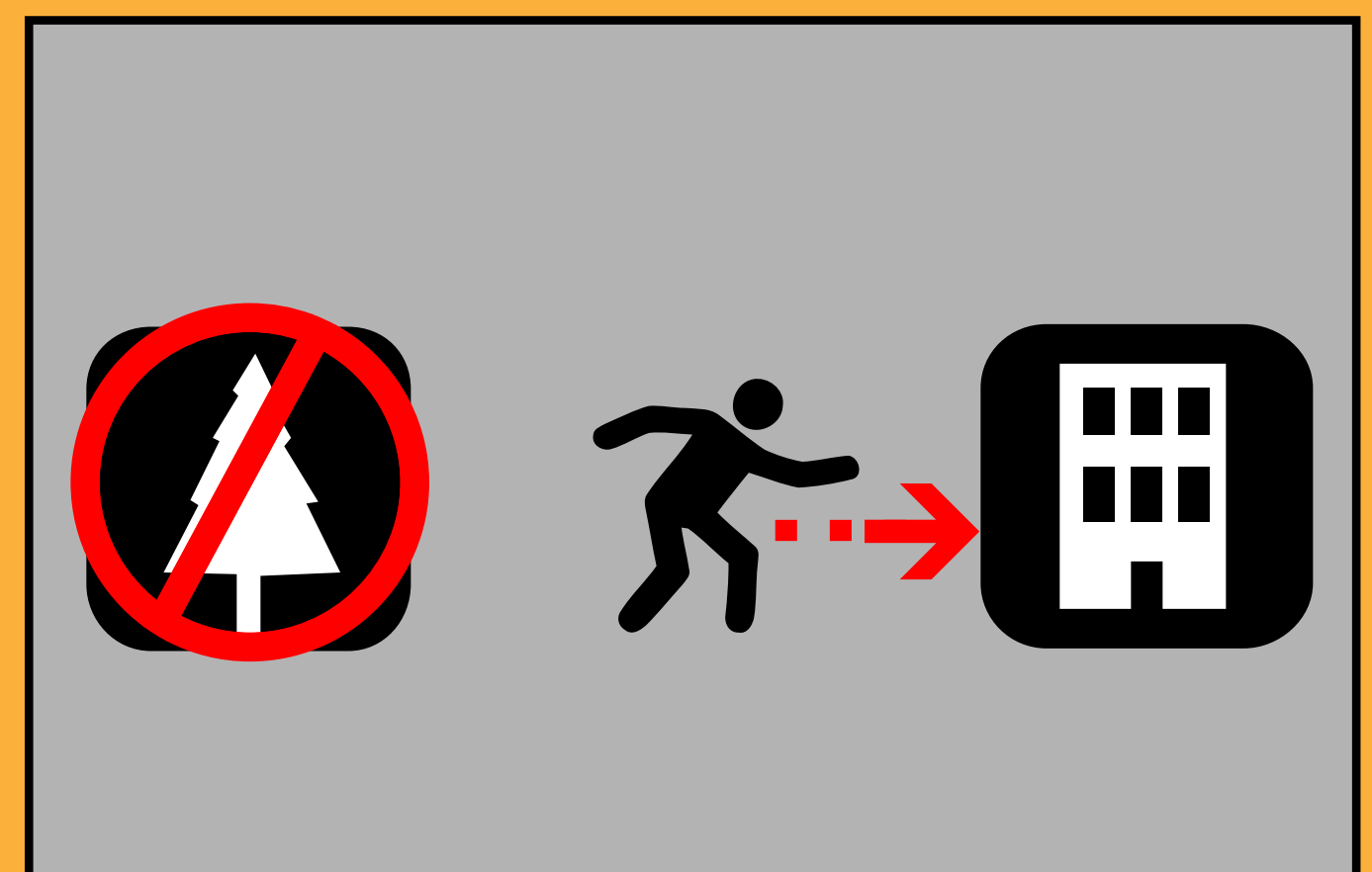

STAY AWAY FROM TREES.  
TAKE SHELTER IN THE NEAREST BUILDING!



# Wind Preparedness

## "Ways to Survive"

A campaign sponsored by the Bellevue Office of Emergency Management

