

OVERLAY NOTES

- ① PROVIDE AND INSTALL CATCH BASIN INLET PROTECTION PER CITY OF BELLEVUE BPM C220.
- ④ CONSTRUCT FULL DEPTH PAVEMENT REPAIR PER DETAILS, SHEET 3.
- ⑥ REMOVE EXISTING CEMENT CONCRETE SIDEWALK OR ASPHALT CONCRETE SIDEWALK AS DIRECTED BY THE ENGINEER.
- ⑦ CONSTRUCT CEMENT CONCRETE SIDEWALK, 5" DEPTH, PER TYPICAL ROADWAY SECTION DETAILS, SHEET 3.

30% PRELIMINARY DESIGN
FOR DISCUSSION ONLY

LEGEND

- FULL DEPTH PAVEMENT REPAIR
SEE DETAILS, SHEET 3
- HMA CL. 1/2" OVERLAY
SEE DETAILS, SHEET 3
- CONCRETE SIDEWALK REPAIR
SEE DETAILS, SHEET 3
- BUTT JOINT LOCATION
SEE DETAIL, SHEET 3

SITE SPECIFIC NOTES, 116TH AVE NE, NE 12TH ST TO NORTHUP WAY

1. FULL WIDTH GRIND 2"
2. OVERLAY WITH 2" OF 1/2" HMA, PG 70-22.
3. WEEKDAY WORK HOURS SHALL BE 7:00 AM TO 5:00 PM.
4. ALL GRINDING AND PAVING OPERATIONS AT AND WITHIN 300 FT OF THE NE 12TH ST AND 116TH AVE NE INTERSECTION SHALL BE PERFORMED ON WEEKENDS BETWEEN THE HOURS OF 9:00 AM AND 6:00 PM.
5. THE CONTRACTOR SHALL UTILIZE VMS SIGNS TO WARN MOTORISTS OF GRIND & PAVE OPERATIONS 72 HOURS BEFORE THE PLANNED ACTIVITIES.

GENERAL NOTES

1. CALL UTILITIES UNDERGROUND LOCATION CENTER AT 811 48 HOURS PRIOR TO CONSTRUCTION.
2. STATIONING SHOWN ON PLANS IS APPROXIMATE.
3. PLACE ONE BLUE TYPE 2 RAISED PAVEMENT MARKER AT EACH FIRE HYDRANT PER SPECIFICATION SECTION 8-09.1.
4. ALL CITY OF BELLEVUE UTILITY MANHOLES, CATCH BASINS AND WATER VALVES SHALL BE ADJUSTED TO FINISHED GRADE PER CITY OF BELLEVUE DETAILS IN APPENDIX A OF THE PROJECT SPECIFICATIONS.

TRAFFIC CONTROL NOTES

1. TWO-WAY TRAFFIC SHALL BE MAINTAINED AT ALL TIMES UNLESS OTHERWISE APPROVED BY THE CITY.
2. THE HOURS FOR CONSTRUCTION ACTIVITY AND LANE CLOSURES ARE SPECIFIED IN THE RIGHT OF WAY PERMIT CONDITIONS AND THE PROJECT SPECIFICATIONS. A TEMPORARY TRAFFIC CONTROL PLAN WILL BE REQUIRED FOR ALL ACTIVITIES THAT MAY IMPACT TRAFFIC AND WILL NOTE THE HOURS AS INDICATED IN THE SPECIFICATIONS FOR THAT SITE.
3. CONTRACTOR SHALL PROVIDE PROJECT SPECIFIC TRAFFIC CONTROL PLANS AT LEAST 10 DAYS PRIOR TO CONSTRUCTION.

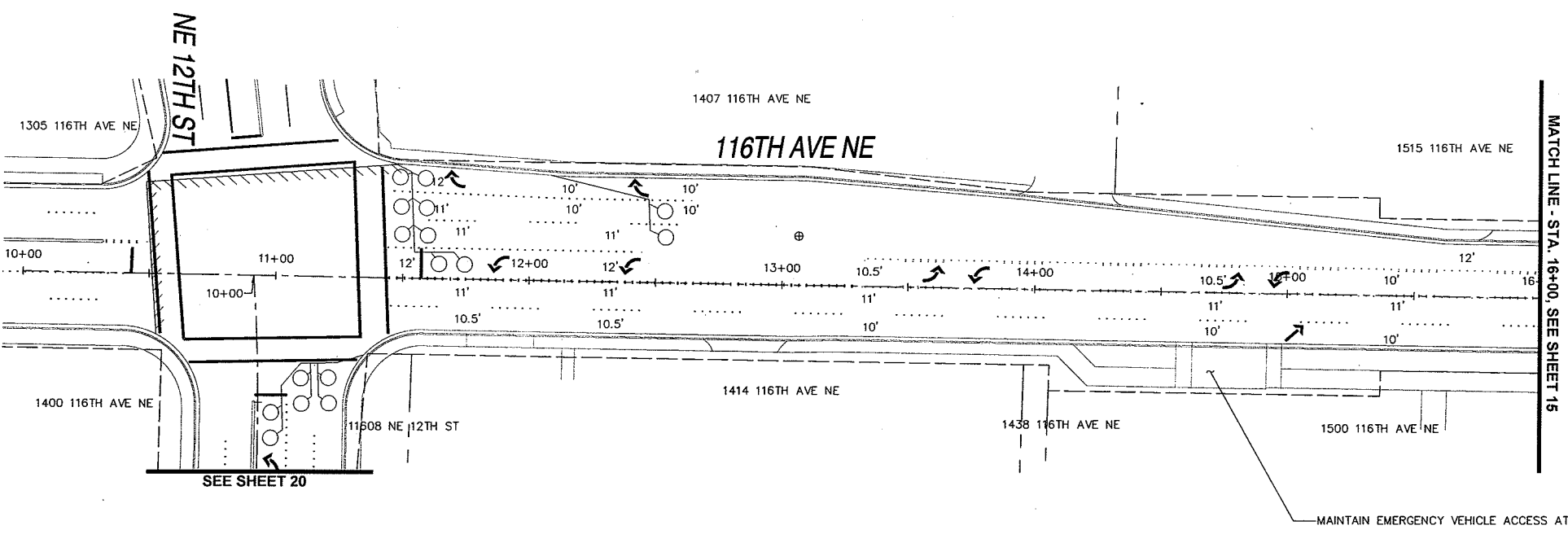

NO.	DATE	BY	APPR.	REVISIONS

Approved By

TRANSPORTATION DESIGN MANAGER _____ DATE _____

PROJECT MANAGER _____ DATE _____

K. Lott/G. Lucas 11/14
DESIGNED BY DATE

G. Lucas 11/14
DRAWN BY DATE

K. Lott 11/14
CHECKED BY DATE



DRAFT - Not for Construction

2015 OVERLAY PROGRAM
116TH AVE NE
NE 12TH ST TO NORTHUP WAY

OVERLAY AND CHANNELIZATION PLAN
STA. 10+00 - 16+00

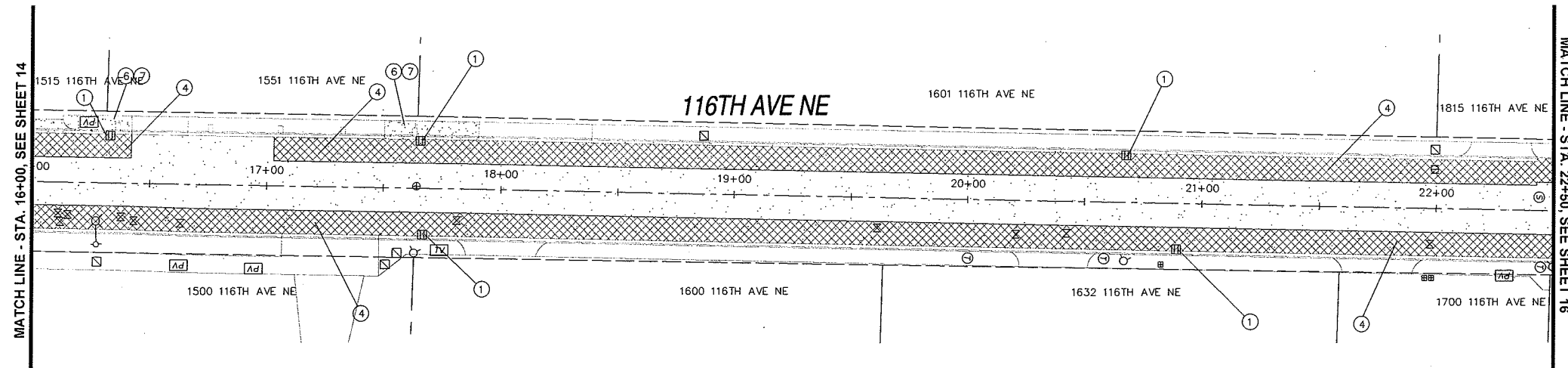
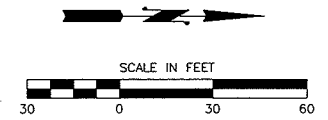

OVERLAY NOTES

- ① PROVIDE AND INSTALL CATCH BASIN INLET PROTECTION PER CITY OF BELLEVUE BPM C220.
- ④ CONSTRUCT FULL DEPTH PAVEMENT REPAIR PER DETAILS, SHEET 3.
- ⑥ REMOVE EXISTING CEMENT CONCRETE SIDEWALK OR ASPHALT CONCRETE SIDEWALK AS DIRECTED BY THE ENGINEER.
- ⑦ CONSTRUCT CEMENT CONCRETE SIDEWALK, 5" DEPTH, PER TYPICAL ROADWAY SECTION DETAILS, SHEET 3.

30% PRELIMINARY DESIGN
FOR DISCUSSION ONLY

LEGEND

- FULL DEPTH PAVEMENT REPAIR
SEE DETAILS, SHEET 3
- HMA CL. 1/2" OVERLAY
SEE DETAILS, SHEET 3
- CONCRETE SIDEWALK REPAIR
SEE DETAILS, SHEET 3
- BUTT JOINT LOCATION
SEE DETAIL, SHEET 3

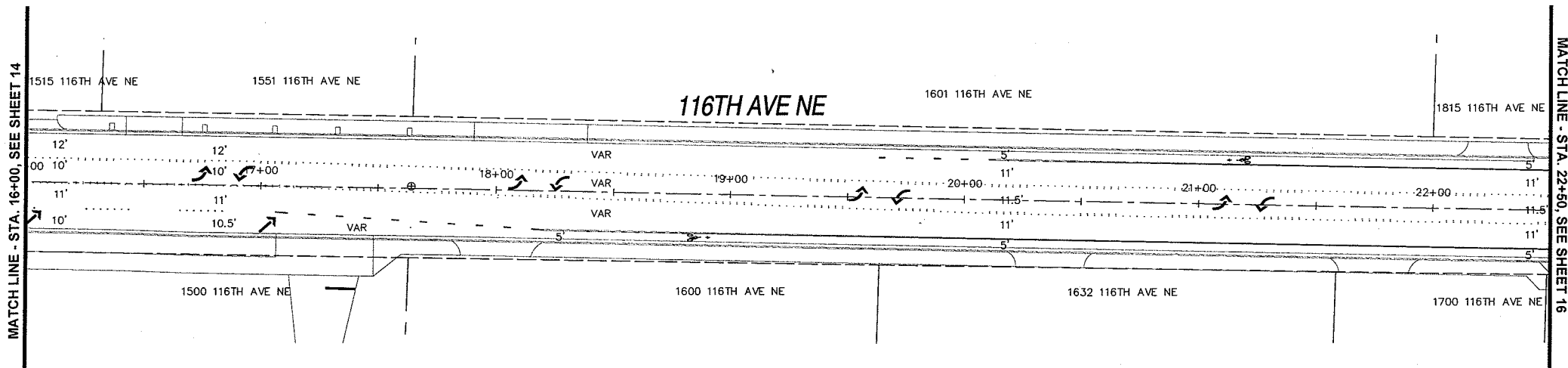

GENERAL NOTES

1. CALL UTILITIES UNDERGROUND LOCATION CENTER AT 811 48 HOURS PRIOR TO CONSTRUCTION.
2. STATIONING SHOWN ON PLANS IS APPROXIMATE.
3. PLACE ONE BLUE TYPE 2 RAISED PAVEMENT MARKER AT EACH FIRE HYDRANT PER SPECIFICATION SECTION 8-09.1.
4. ALL CITY OF BELLEVUE UTILITY MANHOLES, CATCH BASINS AND WATER VALVES SHALL BE ADJUSTED TO FINISHED GRADE PER CITY OF BELLEVUE DETAILS IN APPENDIX A OF THE PROJECT SPECIFICATIONS.

TRAFFIC CONTROL NOTES

1. TWO-WAY TRAFFIC SHALL BE MAINTAINED AT ALL TIMES UNLESS OTHERWISE APPROVED BY THE CITY.
2. THE HOURS FOR CONSTRUCTION ACTIVITY AND LANE CLOSURES ARE SPECIFIED IN THE RIGHT OF WAY PERMIT CONDITIONS AND THE PROJECT SPECIFICATIONS. A TEMPORARY TRAFFIC CONTROL PLAN WILL BE REQUIRED FOR ALL ACTIVITIES THAT MAY IMPACT TRAFFIC AND WILL NOTE THE HOURS AS INDICATED IN THE SPECIFICATIONS FOR THAT SITE.
3. CONTRACTOR SHALL PROVIDE PROJECT SPECIFIC TRAFFIC CONTROL PLANS AT LEAST 10 DAYS PRIOR TO CONSTRUCTION.

NO.	DATE	BY	APPR.	REVISIONS

Approved By

TRANSPORTATION DESIGN MANAGER _____ DATE _____

PROJECT MANAGER _____ DATE _____

K. Latt/G. Lucas 11/14
DESIGNED BY DATE

G. Lucas 11/14
DRAWN BY DATE

K. Latt 11/14
CHECKED BY DATE



DRAFT - Not for Construction

2015 OVERLAY PROGRAM
116TH AVE NE
NE 12TH ST TO NORTHUP WAY

OVERLAY AND CHANNELIZATION PLAN
STA. 16+00 - 22+50

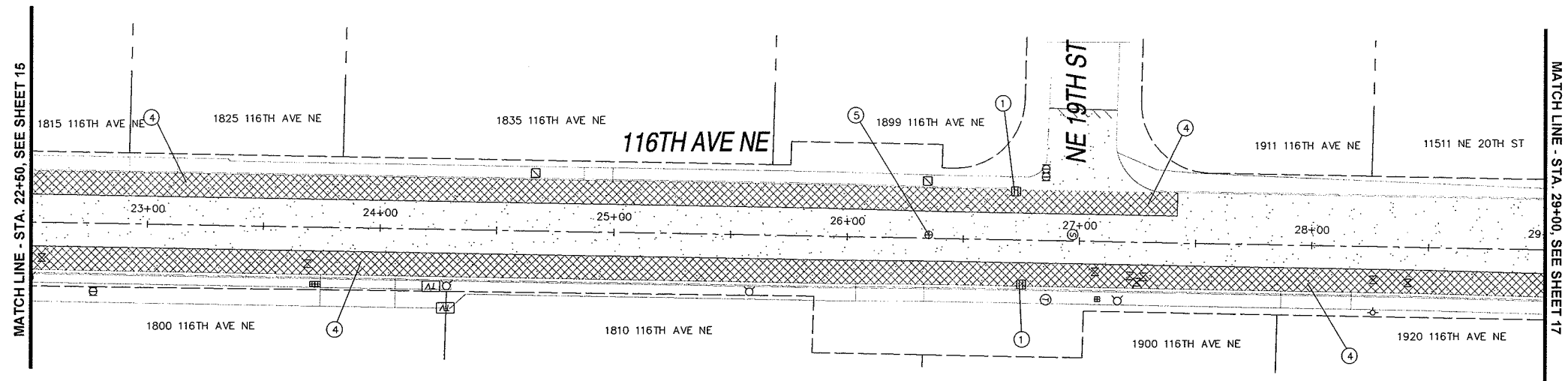
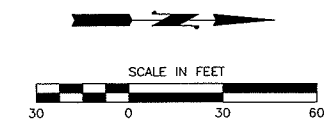

OVERLAY NOTES

- ① PROVIDE AND INSTALL CATCH BASIN INLET PROTECTION PER CITY OF BELLEVUE BPM C220.
- ④ CONSTRUCT FULL DEPTH PAVEMENT REPAIR PER DETAILS, SHEET 3.
- ⑤ ADJUST MONUMENT CASE TO FINISHED GRADE.

30% PRELIMINARY DESIGN
FOR DISCUSSION ONLY

LEGEND

- FULL DEPTH PAVEMENT REPAIR
SEE DETAILS, SHEET 3
- HMA CL. 1/2" OVERLAY
SEE DETAILS, SHEET 3
- CONCRETE SIDEWALK REPAIR
SEE DETAILS, SHEET 3
- BUTT JOINT LOCATION
SEE DETAIL, SHEET 3

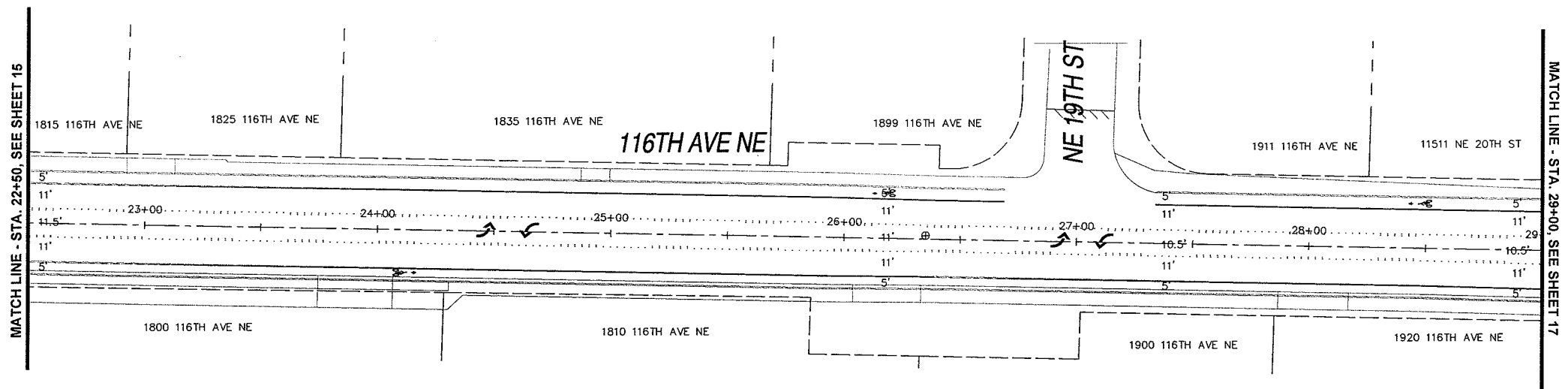

GENERAL NOTES

1. CALL UTILITIES UNDERGROUND LOCATION CENTER AT 811 48 HOURS PRIOR TO CONSTRUCTION.
2. STATIONING SHOWN ON PLANS IS APPROXIMATE.
3. PLACE ONE BLUE TYPE 2 RAISED PAVEMENT MARKER AT EACH FIRE HYDRANT PER SPECIFICATION SECTION 8-09.1.
4. ALL CITY OF BELLEVUE UTILITY MANHOLES, CATCH BASINS AND WATER VALVES SHALL BE ADJUSTED TO FINISHED GRADE PER CITY OF BELLEVUE DETAILS IN APPENDIX A OF THE PROJECT SPECIFICATIONS.

TRAFFIC CONTROL NOTES

1. TWO-WAY TRAFFIC SHALL BE MAINTAINED AT ALL TIMES UNLESS OTHERWISE APPROVED BY THE CITY.
2. THE HOURS FOR CONSTRUCTION ACTIVITY AND LANE CLOSURES ARE SPECIFIED IN THE RIGHT OF WAY PERMIT CONDITIONS AND THE PROJECT SPECIFICATIONS. A TEMPORARY TRAFFIC CONTROL PLAN WILL BE REQUIRED FOR ALL ACTIVITIES THAT MAY IMPACT TRAFFIC AND WILL NOTE THE HOURS AS INDICATED IN THE SPECIFICATIONS FOR THAT SITE.
3. CONTRACTOR SHALL PROVIDE PROJECT SPECIFIC TRAFFIC CONTROL PLANS AT LEAST 10 DAYS PRIOR TO CONSTRUCTION.

NO.	DATE	BY	APPR.	REVISIONS

Approved By

TRANSPORTATION DESIGN MANAGER _____ DATE _____

PROJECT MANAGER _____ DATE _____

K. Latt/G. Lucas 11/14
DESIGNED BY DATE

G. Lucas 11/14
DRAWN BY DATE

K. Latt 11/14
CHECKED BY DATE



DRAFT - Not for Construction

2015 OVERLAY PROGRAM
116TH AVE NE
NE 12TH ST TO NORTHUP WAY

OVERLAY AND CHANNELIZATION PLAN
STA. 22+50 - 29+00

SHT 16 OF 74

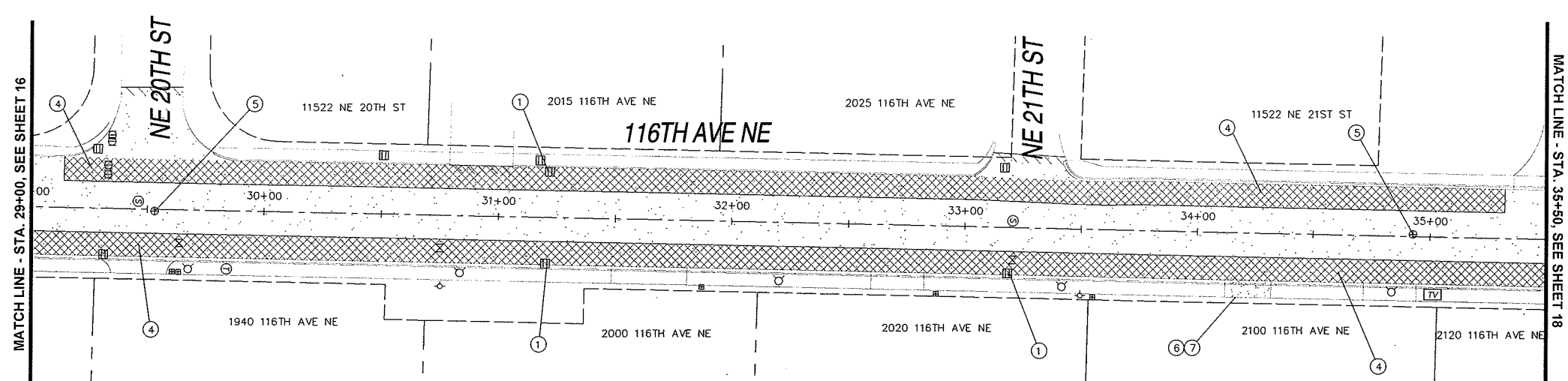
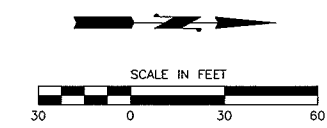

OVERLAY NOTES

- ① PROVIDE AND INSTALL CATCH BASIN INLET PROTECTION PER CITY OF BELLEVUE BPM C220.
- ④ CONSTRUCT FULL DEPTH PAVEMENT REPAIR PER DETAILS, SHEET 3.
- ⑤ ADJUST MONUMENT CASE TO FINISHED GRADE.
- ⑥ REMOVE EXISTING CEMENT CONCRETE SIDEWALK OR ASPHALT CONCRETE SIDEWALK AS DIRECTED BY THE ENGINEER.
- ⑦ CONSTRUCT CEMENT CONCRETE SIDEWALK, 5" DEPTH, PER TYPICAL ROADWAY SECTION DETAILS, SHEET 3.

30% PRELIMINARY DESIGN
FOR DISCUSSION ONLY

LEGEND

- FULL DEPTH PAVEMENT REPAIR
SEE DETAILS, SHEET 3
- HMA CL. 1/2" OVERLAY
SEE DETAILS, SHEET 3
- CONCRETE SIDEWALK REPAIR
SEE DETAILS, SHEET 3
- BUTT JOINT LOCATION
SEE DETAIL, SHEET 3

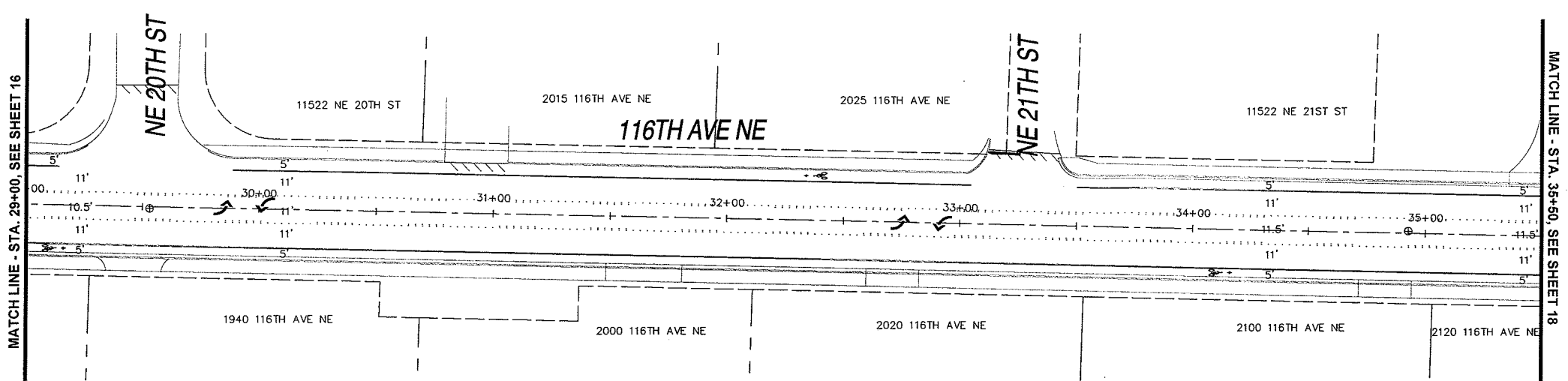

GENERAL NOTES

1. CALL UTILITIES UNDERGROUND LOCATION CENTER AT 811 48 HOURS PRIOR TO CONSTRUCTION.
2. STATIONING SHOWN ON PLANS IS APPROXIMATE.
3. PLACE ONE BLUE TYPE 2 RAISED PAVEMENT MARKER AT EACH FIRE HYDRANT PER SPECIFICATION SECTION 8-09.1.
4. ALL CITY OF BELLEVUE UTILITY MANHOLES, CATCH BASINS AND WATER VALVES SHALL BE ADJUSTED TO FINISHED GRADE PER CITY OF BELLEVUE DETAILS IN APPENDIX A OF THE PROJECT SPECIFICATIONS.

TRAFFIC CONTROL NOTES

1. TWO-WAY TRAFFIC SHALL BE MAINTAINED AT ALL TIMES UNLESS OTHERWISE APPROVED BY THE CITY.
2. THE HOURS FOR CONSTRUCTION ACTIVITY AND LANE CLOSURES ARE SPECIFIED IN THE RIGHT OF WAY PERMIT CONDITIONS AND THE PROJECT SPECIFICATIONS. A TEMPORARY TRAFFIC CONTROL PLAN WILL BE REQUIRED FOR ALL ACTIVITIES THAT MAY IMPACT TRAFFIC AND WILL NOTE THE HOURS AS INDICATED IN THE SPECIFICATIONS FOR THAT SITE.
3. CONTRACTOR SHALL PROVIDE PROJECT SPECIFIC TRAFFIC CONTROL PLANS AT LEAST 10 DAYS PRIOR TO CONSTRUCTION.

<table border="1" style="width: 100%; border-collapse: collapse;"> <thead> <tr> <th>NO.</th> <th>DATE</th> <th>BY</th> <th>APPR.</th> <th>REVISIONS</th> </tr> </thead> <tbody> <tr><td> </td><td> </td><td> </td><td> </td><td> </td></tr> <tr><td> </td><td> </td><td> </td><td> </td><td> </td></tr> <tr><td> </td><td> </td><td> </td><td> </td><td> </td></tr> </tbody> </table>	NO.	DATE	BY	APPR.	REVISIONS																<p>Approved By</p> <table border="1" style="width: 100%; border-collapse: collapse;"> <tr> <td style="width: 60%;">TRANSPORTATION DESIGN MANAGER</td> <td style="width: 40%;">DATE</td> </tr> <tr> <td>PROJECT MANAGER</td> <td>DATE</td> </tr> </table>	TRANSPORTATION DESIGN MANAGER	DATE	PROJECT MANAGER	DATE	<table border="1" style="width: 100%; border-collapse: collapse;"> <tr> <td style="width: 30%;">DESIGNED BY</td> <td style="width: 30%;">DATE</td> <td style="width: 40%;">K. Lott/G. Lucas</td> <td style="width: 10%;">11/14</td> </tr> <tr> <td>DRAWN BY</td> <td>DATE</td> <td>G. Lucas</td> <td>11/14</td> </tr> <tr> <td>CHECKED BY</td> <td>DATE</td> <td>K. Lott</td> <td>11/14</td> </tr> </table>	DESIGNED BY	DATE	K. Lott/G. Lucas	11/14	DRAWN BY	DATE	G. Lucas	11/14	CHECKED BY	DATE	K. Lott	11/14	<p>City of Bellevue Transportation Department</p>	<p style="transform: rotate(-45deg); font-weight: bold;">DRAFT - Not for Construction</p>	<p>2015 OVERLAY PROGRAM 116TH AVE NE NE 12TH ST TO NORTHUP WAY</p>		<p>OVERLAY AND CHANNELIZATION PLAN STA. 29+00 - 35+50</p>	<p>SHT <u>17</u> OF <u>74</u></p>
NO.	DATE	BY	APPR.	REVISIONS																																								
TRANSPORTATION DESIGN MANAGER	DATE																																											
PROJECT MANAGER	DATE																																											
DESIGNED BY	DATE	K. Lott/G. Lucas	11/14																																									
DRAWN BY	DATE	G. Lucas	11/14																																									
CHECKED BY	DATE	K. Lott	11/14																																									

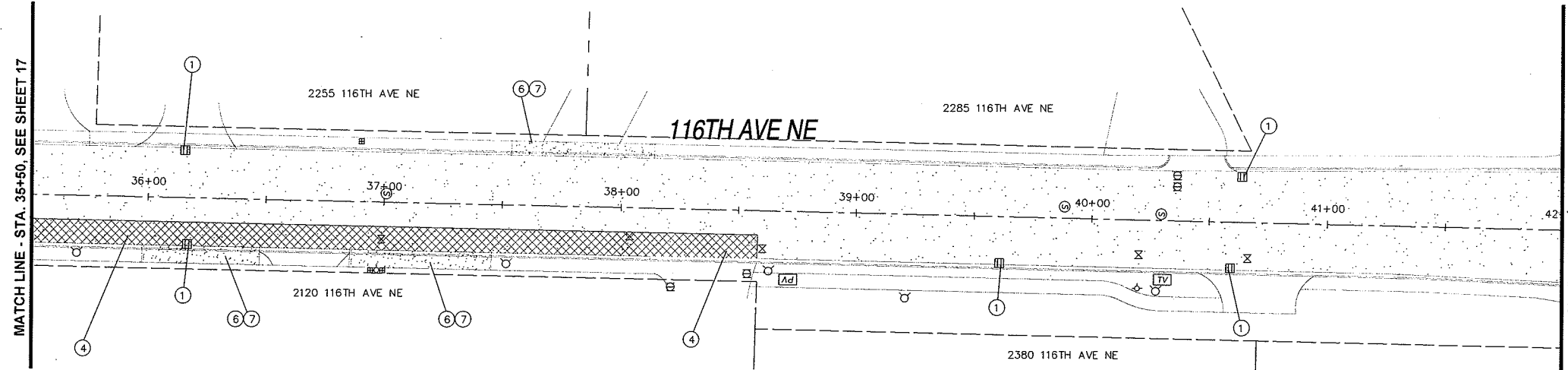
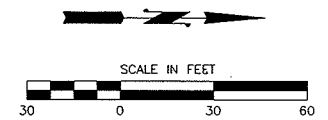

OVERLAY NOTES

- ① PROVIDE AND INSTALL CATCH BASIN INLET PROTECTION PER CITY OF BELLEVUE BPM C220.
- ④ CONSTRUCT FULL DEPTH PAVEMENT REPAIR PER DETAILS, SHEET 3.
- ⑥ REMOVE EXISTING CEMENT CONCRETE SIDEWALK OR ASPHALT CONCRETE SIDEWALK AS DIRECTED BY THE ENGINEER.
- ⑦ CONSTRUCT CEMENT CONCRETE SIDEWALK, 5" DEPTH, PER TYPICAL ROADWAY SECTION DETAILS, SHEET 3.

30% PRELIMINARY DESIGN
FOR DISCUSSION ONLY

LEGEND

- FULL DEPTH PAVEMENT REPAIR
SEE DETAILS, SHEET 3
- HMA CL. 1/2" OVERLAY
SEE DETAILS, SHEET 3
- CONCRETE SIDEWALK REPAIR
SEE DETAILS, SHEET 3
- BUTT JOINT LOCATION
SEE DETAIL, SHEET 3

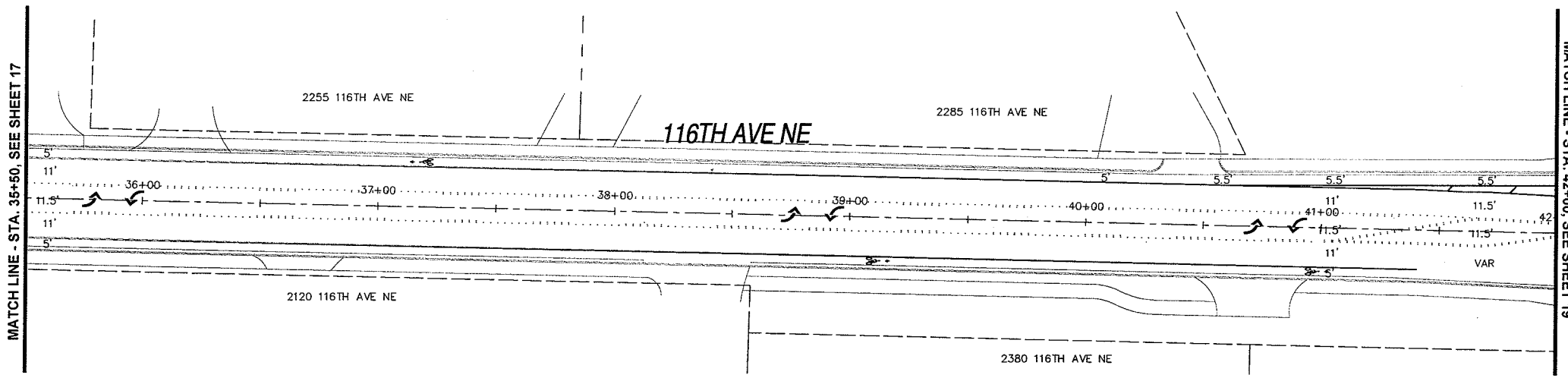

GENERAL NOTES

1. CALL UTILITIES UNDERGROUND LOCATION CENTER AT 811 48 HOURS PRIOR TO CONSTRUCTION.
2. STATIONING SHOWN ON PLANS IS APPROXIMATE.
3. PLACE ONE BLUE TYPE 2 RAISED PAVEMENT MARKER AT EACH FIRE HYDRANT PER SPECIFICATION SECTION 8-09.1.
4. ALL CITY OF BELLEVUE UTILITY MANHOLES, CATCH BASINS AND WATER VALVES SHALL BE ADJUSTED TO FINISHED GRADE PER CITY OF BELLEVUE DETAILS IN APPENDIX A OF THE PROJECT SPECIFICATIONS.

TRAFFIC CONTROL NOTES

1. TWO-WAY TRAFFIC SHALL BE MAINTAINED AT ALL TIMES UNLESS OTHERWISE APPROVED BY THE CITY.
2. THE HOURS FOR CONSTRUCTION ACTIVITY AND LANE CLOSURES ARE SPECIFIED IN THE RIGHT OF WAY PERMIT CONDITIONS AND THE PROJECT SPECIFICATIONS. A TEMPORARY TRAFFIC CONTROL PLAN WILL BE REQUIRED FOR ALL ACTIVITIES THAT MAY IMPACT TRAFFIC AND WILL NOTE THE HOURS AS INDICATED IN THE SPECIFICATIONS FOR THAT SITE.
3. CONTRACTOR SHALL PROVIDE PROJECT SPECIFIC TRAFFIC CONTROL PLANS AT LEAST 10 DAYS PRIOR TO CONSTRUCTION.

NO.	DATE	BY	APPR.	REVISIONS

Approved By	
TRANSPORTATION DESIGN MANAGER	DATE
PROJECT MANAGER	DATE
	DATE

K. Latt/G. Lucas 11/14
DESIGNED BY DATE
G. Lucas 11/14
DRAWN BY DATE
K. Latt 11/14
CHECKED BY DATE



DRAFT - Not for Construction

2015 OVERLAY PROGRAM
116TH AVE NE
NE 12TH ST TO NORTHUP WAY

OVERLAY AND CHANNELIZATION PLAN
STA. 35+50 - 42+00

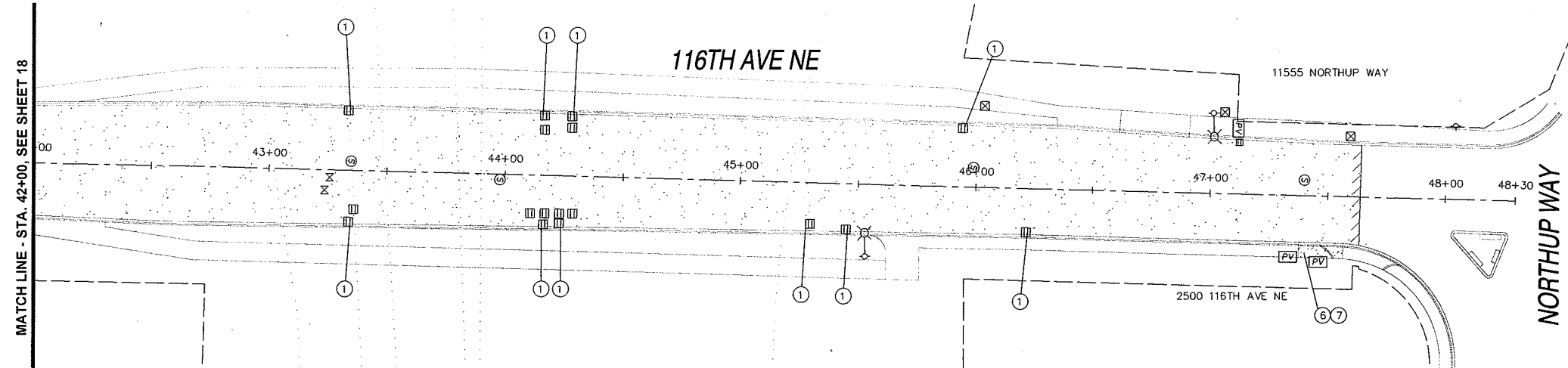
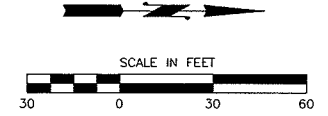

OVERLAY NOTES

- ① PROVIDE AND INSTALL CATCH BASIN INLET PROTECTION PER CITY OF BELLEVUE BPM C220.
- ⑥ REMOVE EXISTING CEMENT CONCRETE SIDEWALK OR ASPHALT CONCRETE SIDEWALK AS DIRECTED BY THE ENGINEER.
- ⑦ CONSTRUCT CEMENT CONCRETE SIDEWALK, 5" DEPTH, PER TYPICAL ROADWAY SECTION DETAILS, SHEET 3.

30% PRELIMINARY DESIGN
FOR DISCUSSION ONLY

LEGEND

- FULL DEPTH PAVEMENT REPAIR
SEE DETAILS, SHEET 3
- HMA CL. 1/2" OVERLAY
SEE DETAILS, SHEET 3
- CONCRETE SIDEWALK REPAIR
SEE DETAILS, SHEET 3
- BUTT JOINT LOCATION
SEE DETAIL, SHEET 3

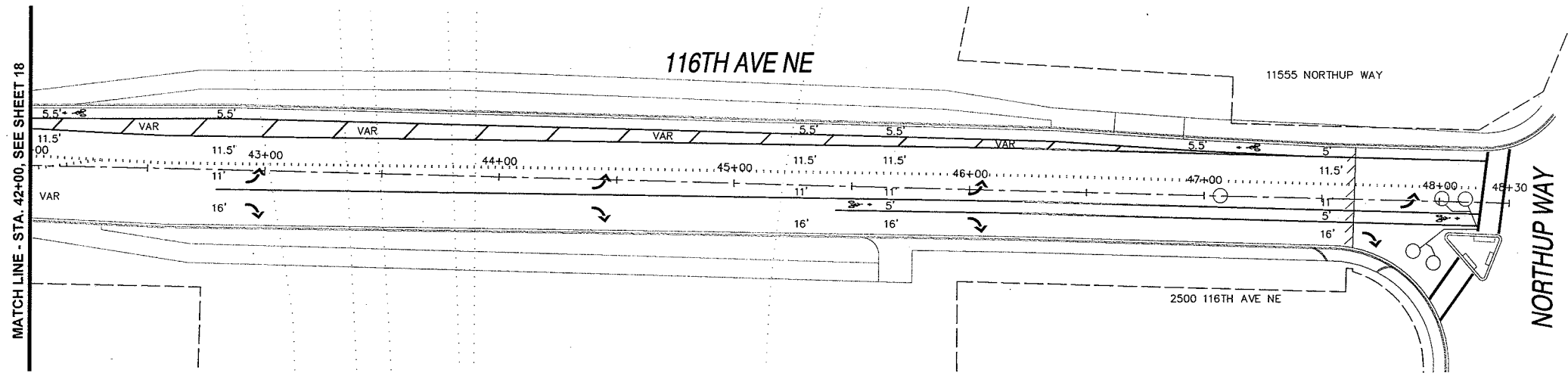

GENERAL NOTES

1. CALL UTILITIES UNDERGROUND LOCATION CENTER AT 811 48 HOURS PRIOR TO CONSTRUCTION.
2. STATIONING SHOWN ON PLANS IS APPROXIMATE.
3. PLACE ONE BLUE TYPE 2 RAISED PAVEMENT MARKER AT EACH FIRE HYDRANT PER SPECIFICATION SECTION 8-09.1.
4. ALL CITY OF BELLEVUE UTILITY MANHOLES, CATCH BASINS AND WATER VALVES SHALL BE ADJUSTED TO FINISHED GRADE PER CITY OF BELLEVUE DETAILS IN APPENDIX A OF THE PROJECT SPECIFICATIONS.

TRAFFIC CONTROL NOTES

1. TWO-WAY TRAFFIC SHALL BE MAINTAINED AT ALL TIMES UNLESS OTHERWISE APPROVED BY THE CITY.
2. THE HOURS FOR CONSTRUCTION ACTIVITY AND LANE CLOSURES ARE SPECIFIED IN THE RIGHT OF WAY PERMIT CONDITIONS AND THE PROJECT SPECIFICATIONS. A TEMPORARY TRAFFIC CONTROL PLAN WILL BE REQUIRED FOR ALL ACTIVITIES THAT MAY IMPACT TRAFFIC AND WILL NOTE THE HOURS AS INDICATED IN THE SPECIFICATIONS FOR THAT SITE.
3. CONTRACTOR SHALL PROVIDE PROJECT SPECIFIC TRAFFIC CONTROL PLANS AT LEAST 10 DAYS PRIOR TO CONSTRUCTION.

NO.	DATE	BY	APPR.	REVISIONS

Approved By

TRANSPORTATION DESIGN MANAGER DATE

PROJECT MANAGER DATE

K. Latt/G. Lucas 11/14
DESIGNED BY DATE

G. Lucas 11/14
DRAWN BY DATE

K. Latt 11/14
CHECKED BY DATE



DRAFT - Not for Construction

2015 OVERLAY PROGRAM
116TH AVE NE
NE 12TH ST TO NORTHUP WAY

OVERLAY AND CHANNELIZATION PLAN
STA. 42+00 - 47+76